

Microcassette™ - Corder

Operating Instructions

操作說明書 (在背面)

M-650V/560V/455/450

Sony Corporation ©2002



http://www.sony.net/

About This Manual

The instructions in this manual are for 4 models. The M-650V is the model used for illustration purposes. Their differences are shown in the table below:

	M-650V	M-560V	M-455/M-450
Tape counter	○	○	—
MIC jack	○	—	—
REC lamp	○	—	—
BATT/⊞ lamp	○	—	—
REC/BATT lamp	—	○	—
BATT lamp	—	—	○
VOR	○	○	—
FAST PB	○	—	—
Handstrap	○	—	—

○: provided or supplied
—: not provided or not supplied

There is no difference between M-455 and M-450 except for the supplied accessories. For information about the supplied accessories, see "Specifications" of this manual.

Preparing Power Sources

Choose one of the following power sources.

Dry Batteries

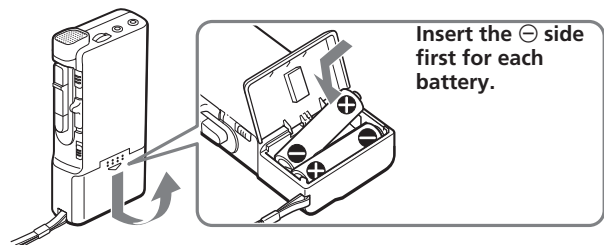

Make sure that nothing is connected to the DC IN 3V jack.

- 1 Open the battery compartment lid.
- 2 Insert two R6 (size AA) batteries with correct polarity and close the lid.

To take out the batteries

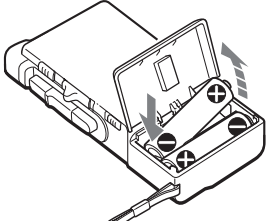

If the battery compartment lid is accidentally detached

Attach it as illustrated.

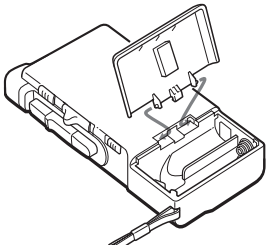

When to replace the batteries

For M-560V/455/450
Replace the batteries with new ones when the REC/BATT (M-560V) or BATT (M-455/450) lamp dims.

For M-650V
Replace the batteries with new ones when the BATT lamps go off and the ⊞ lamp flashes.

Notes

- The unit will play back normally for a while, even after the ⊞ lamp flashes. However, replace the batteries as soon as you can. If you do not, the playback cannot be made with normal sound, noise may be recorded and the recorded sound will not be loud enough (M-650V only).
- In the following cases you do not need to replace the batteries:
 - if the REC/BATT or BATT lamp flashes with the playback sound when you turn up the volume.
 - if the ⊞ lamp lights momentarily when the tape starts running or at the end of the tape (M-650V only).
 - if the ⊞ lamp flashes during FF (CUE) or REW (REVIEW) (M-650V only).

Battery life (Approx. hours) (JEITA*)

Batteries	Recording	
Sony manganese R6P (SR)	8 (M-650V only)	10 (M-560V/455/450 only)
Sony alkaline LR6 (SG)**	26 (M-650V only)	30 (M-560V/455/450 only)

* Measured valued by the standard of JEITA (Japan Electronics and Information Technology Industries Association) (Using a Sony Microcassette)

**When using a Sony LR6 (SG) "STAMINA" alkaline dry batteries (produced in Japan)

Note

The battery life may shorten depending on the operation of the unit.

House current

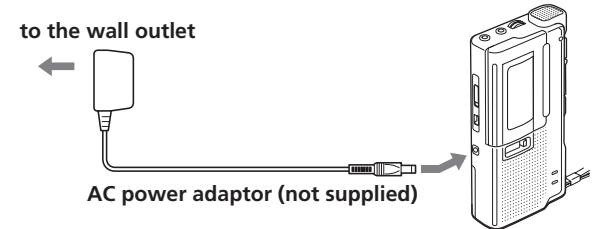

Connect the AC power adaptor to DC IN 3V and to a wall outlet. Use the AC-E30HG AC power adaptor (not supplied.)

Polarity of the plug



Note

Specifications for AC-E30HG vary for each area. Check your local voltage and the shape of plug before purchasing.

Recording

Make sure that nothing is connected to MIC (M-650V only).

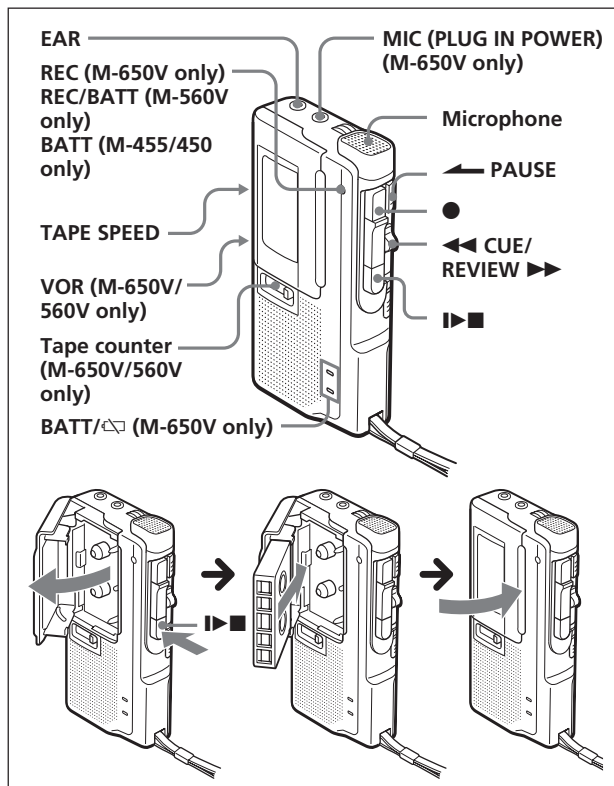

- 1 Press the reset button of the tape counter (M-650V/560V only).
- 2 Press **▶■** and insert a standard microcassette with the side to start recording facing the lid.
- 3 Select the desired tape speed.
 - 2.4 cm** for optimum sound (recommended for normal use): A 30-minute recording can be made using both sides of the MC-30 microcassette.
 - 1.2 cm** for longer recording time: A 60-minute recording can be made using both sides of the MC-30 microcassette.
- 4 Set VOR to H, L or OFF (M-650V/560V only).
 - If you set VOR to H or L, the unit automatically starts recording the sound and pauses when there is no sound (you can save tapes and batteries).
 - H**: To record at meeting or in a quiet and/or spacious place.
 - L**: To record for dictation or in a noisy place.
 - When the sound is not loud enough, set it to OFF, or the unit may not start recording.
- 5 Press **●**.
 - ▶■** is pressed simultaneously and recording starts. While the tape runs, the REC lamp or REC/BATT lamp lights and flashes depending on the strength of the sound (M-650V/560V only). Recording level is fixed.

To	Press or slide
Stop recording	▶■
Start recording during playback	● during playback (the unit becomes in the recording mode)
Review the portion just recorded	Push up ◀◀CUE/▶▶REVIEW toward ▶▶REVIEW during the recording. Release the button at the point to start playback.
Pause recording	Slide ▶■ PAUSE in the direction of the arrow. The REC/BATT (M-560V), BATT (M-455/450) or REC (M-650V) lamp goes off.
Take out a cassette	▶■

Note

Select the 2.4 cm tape speed for recording, if you play back the recorded tape with another unit. Otherwise, the sound quality may be changed.

Notes on VOR (Voice Operated Recording) (M-650V/560V only)

- The VOR system depends on the environmental conditions. If you cannot get the desired results, set VOR to OFF.
- When you use the unit in a noisy place, it will stay in the recording mode. If the sound is too soft, on the contrary, the unit will not start recording. Set VOR to H (high) or L (low) depending on the conditions.

To monitor the sound

Connect an earphone (not supplied) to EAR jack. The monitor volume cannot be adjusted by VOL.

To prevent a cassette from being accidentally recorded over

Break out and remove the cassette tabs. To reuse the cassette for recording, cover the tab hole with adhesive tape.

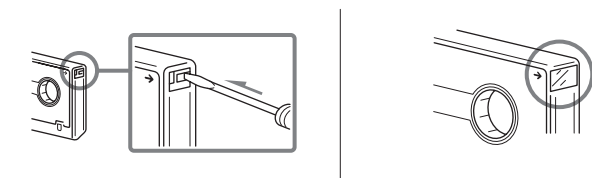

Playing a Tape

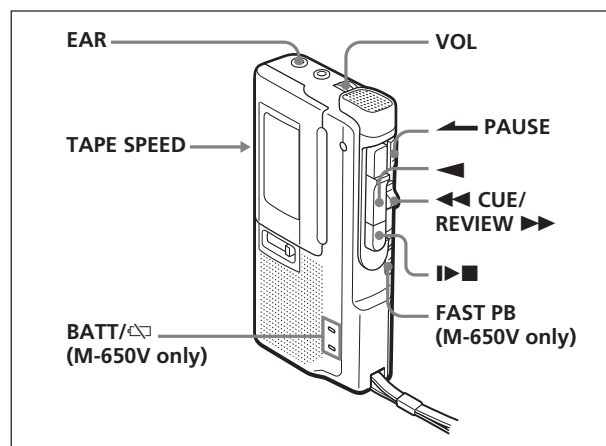

- 1 Insert a cassette with the side to start playing facing the lid.
- 2 Select the tape speed to the same speed as that used for recording.
- 3 Press **▶■**.
- 4 Turn VOL to adjust the volume.

If you plug in headphones (not supplied) to the EAR jack, you will get monaural output from both left and right channels.

To	Press or slide
Stop playback/stop fast forward or rewind*	▶■
Pause playback	Slide ▶■ PAUSE in the direction of the arrow. The REC/BATT (M-560V), BATT (M-455/450) or REC (M-650V) lamp goes off.
Fast forward	Slide ◀◀CUE/▶▶REVIEW toward ◀◀CUE during stop.
Rewind	Slide ◀◀CUE/▶▶REVIEW toward ▶▶REVIEW during stop.
Search forward during playback (CUE)	Keep ◀◀CUE/▶▶REVIEW pushed down toward ◀◀CUE during playback and release it at the point you want.
Search backward during playback (REVIEW)	Keep ◀◀CUE/▶▶REVIEW pushed up toward ▶▶REVIEW during playback and release it at the point you want.

* If you leave the unit after the tape has been wound or rewound, the batteries will be consumed rapidly. Be sure to depress **▶■**.

Note

If the tape is completely wound or rewound while searching forward/backward during playback (CUE/REVIEW), the **◀◀CUE/▶▶REVIEW** switch may not return to the center position when you release the switch. In this case, push back the switch to the center to start playback.

To increase the playback speed (M-650V only)

Slide the FAST PB switch in the direction of the arrow. The playback speed will be increased. To return to the original speed, slide the FAST PB switch to the original position.

At the end of the tape

In the recording or playback mode, the tape stops at the end of the tape and the locked buttons will be released automatically (Automatic shut-off mechanism). After fast forward or rewind, be sure to set **◀◀CUE/▶▶REVIEW** back to the center.

Recording/Playback with the Connected Equipment (M-650V only)

Recording with an External Microphone

Connect a microphone to the MIC jack. Use a microphone of low impedance (less than 3 kΩ) such as ECM-T6 (not supplied). When using a plug-in-power system microphone, the power to the microphone is supplied from this unit.

Note

When recording with an external microphone, the VOR system may not work properly because of the difference in sensitivity.

Recording from another tape recorder

Connect another tape recorder to the MIC jack using the RK-G64HG connecting cord (not supplied). Set this unit to the recording mode and another tape recorder to the playback mode. In this case set VOR to OFF.

Precautions

On power

- Operate the unit only on 3 V DC. For AC operation, use the AC adaptor recommended for the unit. Do not use any other type. For battery operation, use two R6 (size AA) batteries.

On the unit

- Use only the **MICROCASSETTE™** (standard microcassettes) with this unit. Non-standard cassettes cannot be used because their "L" dimension (see illustration) is different.

Standard

Only standard microcassettes have a small indentation of side A.

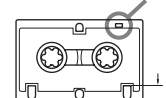

Approx. 5 mm

Non-standard

Non-standard microcassettes do not have the indentation on side A.

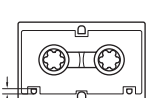

Approx. 2.5 mm

- Do not leave the unit in a location near heat sources, or in a place subject to direct sunlight, excessive dust or mechanical shock.
- Should any solid object or liquid fall into the unit, remove the batteries or disconnect the AC power adaptor, and have the unit checked by qualified personnel before operating it any further.
- Keep personal credit cards using magnetic coding or spring-wound watches etc. away from the unit to prevent possible damage from the magnet used for the speaker.
- When you do not use the unit for long, remove the batteries to avoid damage caused by battery leakage and subsequent corrosion.
- If the unit has not been used for long, set it in the playback mode and warm it up for a few minutes before inserting a cassette.

If you have any questions or problems concerning your unit, please consult your nearest Sony dealer.

Troubleshooting

Should any problem persist after you have made these checks, consult your nearest Sony dealer.

A cassette cannot be inserted.

- The cassette is being inserted in the wrong way.
- **▶■** has been already pressed.

The unit does not operate.

- The batteries have been inserted with incorrect polarity.
- The batteries are weak. Replace both batteries with new ones.
- **▶■** PAUSE is slid in the direction of the arrow.
- The AC power adaptor is connected to the unit only and you are going to use the unit on batteries.

Recording cannot be made.

- There is no cassette in the cassette compartment.
- The tab on the tape has been removed. To reuse the tape for recording, cover the tab hole with adhesive tape.

Recording is interrupted.

- The VOR switch (M-650V/560V only) is set to H or L. When you do not use VOR, set it to OFF.

During CUE/REVIEW the tape stops or does not run. You cannot fast-forward or rewind.

- The batteries are weak. Replace both batteries with new ones.

Recording cannot be erased completely.

- The head is contaminated. See "Maintenance".

Playback cannot be made.

- The tape has reached the end. Rewind the tape.

No sound comes from the speaker.

- The earphone is plugged in.
- The volume is turned down completely.

The sound drops out or comes with excessive noise.

- The volume is turned down completely.
- The batteries are weak. Replace both batteries with new ones.
- The head is contaminated. See "Maintenance".
- Direct placement of the cassette tape on the speaker resulted in magnetization and deteriorated tonal quality.
- Use the unit away from radiowave-emitting devices such as cellular phones.

Tape speed is too fast or too slow in the playback mode.

- Improper setting of the TAPE SPEED switch. Set it to the same speed as that used for recording.
- The batteries are weak. Replace both batteries with new ones.

Tape speed is faster than the normal playback speed.

- The FAST PB switch (M-650V only) is slid in the direction of the arrow.

Maintenance

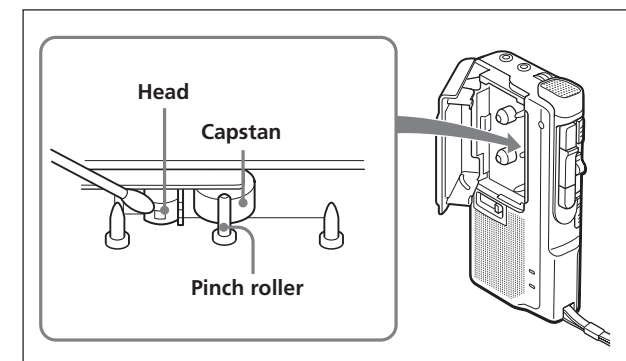

To clean the tape head and path

Press **▶■** and wipe the head, capstan and the pinch roller with a cotton swab, moistened with alcohol every 10 hours of use.

To clean the exterior

Use a soft cloth slightly moistened in water. Do not use alcohol, benzene or thinner.

Specifications

Tape

MICROCASSETTE™ (normal position type)

Recording system

2-track 1-channel monaural

Speaker

Approx. 3.6 cm dia.

Tape speed

2.4 cm/s (¹/₁₆ ips), 1.2 cm/s (¹/₃₂ ips)

Frequency range

300 - 4 000 Hz (with TAPE SPEED switch at 2.4 cm/s)

Input (M-650V only)

Microphone input jack (minijack/PLUG IN POWER) sensitivity 0.24 mV for 3 kΩ or lower impedance microphone

Output

Earphone jack (minijack) for 8 - 300 Ω earphone

Power output (at 10% harmonic distortion)

250 mW

Power requirements

3 V DC batteries R6 (size AA) × 2/External DC 3V power sources

Dimensions (w/h/d)

Approx. 62.2 × 119.1 × 25.4 mm incl. projecting parts and controls

Mass

M-650V: Approx. 115 g (main unit only)

M-560V: Approx. 113 g (main unit only)

M-455/450: Approx. 109 g (main unit only)

Supplied accessories

Microcassette tape MC-30 (1) (M-455 only)

Design and specifications are subject to change without notice.

