

SONY®

4-131-632-74(1)

Micro HI-FI Component System 迷你音响组合

Operating Instructions _____ GB

使用说明书 _____ CS

使用产品前请仔细阅读本使用说明书，
并请妥善保管

CMT-LX30iR

COMPACT
disc
DIGITAL AUDIO

© 2009 Sony Corporation

WARNING

To reduce the risk of fire, do not cover the ventilation opening of the apparatus with newspapers, tablecloths, curtains, etc. Do not place the naked flame sources such as lighted candles on the apparatus.

To reduce the risk of fire or electric shock, do not expose this apparatus to dripping or splashing, and do not place objects filled with liquids, such as vases, on the apparatus.

Do not install the appliance in a confined space, such as a bookcase or built-in cabinet.

As the main plug is used to disconnect the unit from the mains, connect the unit to an easily accessible AC outlet. Should you notice an abnormality in the unit, disconnect the main plug from the AC outlet immediately.

Do not expose batteries or apparatus with battery-installed to excessive heat such as sunshine, fire or the like.

CAUTION

The use of optical instruments with this product will increase eye hazard.

Except for customers in the U.S.A. and Canada

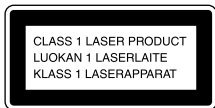

This appliance is classified as a CLASS 1 LASER product. This marking is located on the rear exterior.

Note on DualDiscs

A DualDisc is a two sided disc product which mates DVD recorded material on one side with digital audio material on the other side. However, since the audio material side does not conform to the Compact Disc (CD) standard, playback on this product is not guaranteed.

Music discs encoded with copyright protection technologies

This product is designed to playback discs that conform to the Compact Disc (CD) standard. Recently, various music discs encoded with copyright protection technologies are marketed by some record companies. Please be aware that among those discs, there are some that do not conform to the CD standard and may not be playable by this product.

Note on copyright-protected content

The transferred music is limited to private use only. Use of the music beyond this limit requires permission of the copyright holders.

License and Trademark Notice

- iPod is a trademark of Apple Inc., registered in the U.S. and other countries.
- MPEG Layer-3 audio coding technology and patents licensed from Fraunhofer IIS and Thomson.
- Windows Media is a registered trademark of Microsoft Corporation in the United States and/or other countries.

Table of Contents

Guide to parts and controls 5

Getting Started

Hooking up the system
securely.....10
Setting the clock12

Operations

Playing a CD/MP3 disc 13
Listening to the radio15
Playing the iPod.....16
Before using the USB device with
this system.....17
Transferring music from a disc to a
USB device.....18
Playing a file of the USB device.....22
Creating your own program
(Program Play).....23
Using optional audio
components.....25
Adjusting the sound25
Changing the display26
Using the Timers.....27

Additional Information

Troubleshooting.....29
Messages.....35
Precautions.....37
Specifications39
Compatible iPod models with this
system41

Guide to parts and controls

This manual mainly explains operations using the remote, but the same operations can also be performed using the buttons on the unit having the same or similar names.

Main unit

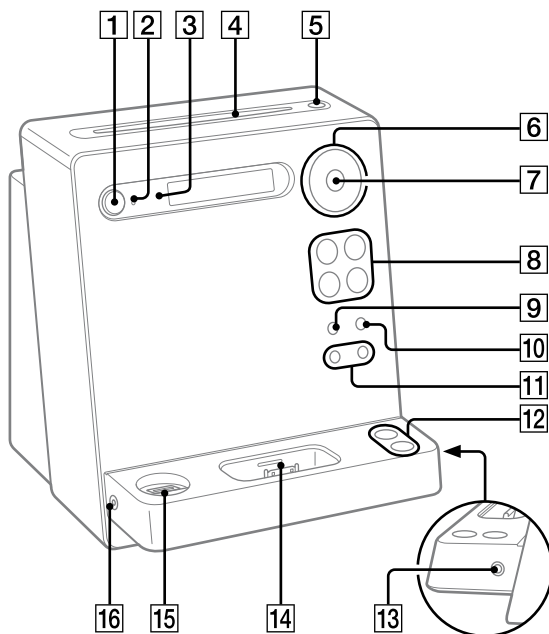

Continued

1

I/⏻ (power) button (page 12, 27)
Press to turn on or off the system.

2

STANDBY indicator (page 26, 29)
Lights up when the system is turned off.

3

Remote sensor (page 30)

4

Disc slot

5

▲ (eject) button
Press to eject a disc.

6

**📁 +/- (select folder) button
(page 13, 19, 20, 22, 23)**
Press to select a folder.

TUNE +/- (tuning) button (page 15)

Press to tune in the desired station.

**⏮/⏭ (go back/go forward)
button (page 13, 16, 20, 22, 23)**
Press to select a track or file.

**⏪/⏩ (rewind/fast forward)
button (page 13, 16, 22)**
Press to find a point in a track or file.

7

**ENTER button (page 12, 15, 16,
19, 20, 27, 28)**
Press to enter the settings.

8

**Playback buttons and function
buttons**

**▶|| (play/pause) button (page
13, 16, 22)**

Press to start or pause playback of a disc,
optional USB device or iPod.

**■ (stop) button (page 13, 15, 16,
20, 22)**

Press to stop playback of a disc or
optional USB device.

Press to pause playback of an iPod.

**FUNCTION +/- button (page 13,
15, 16, 19, 20, 22, 23, 25)**

Press to select the function.

9

USB MENU button (page 20)

Press to erase audio files and folders from
the connected optional USB device.

Press to select which memory to read
to if the USB device has more than one
memory.

10

REC TO USB button (page 19)
Press to transfer music from a disc to the connected optional USB device.

11

Sound buttons
EQ button (page 25)
DSGX button (page 25)
Press to select the sound effect.

12

VOLUME +/- button
Press to adjust the volume.

13

AUDIO IN jack
Connect an optional audio component.

14

iPod Dock (page 11)
Place an iPod into the iPod Dock to listen to audio contents stored in the iPod.

15

⌂ (USB) port (page 18, 19, 20, 22)
Connect an optional USB device.

16

PHONES jack
Connect the headphones.

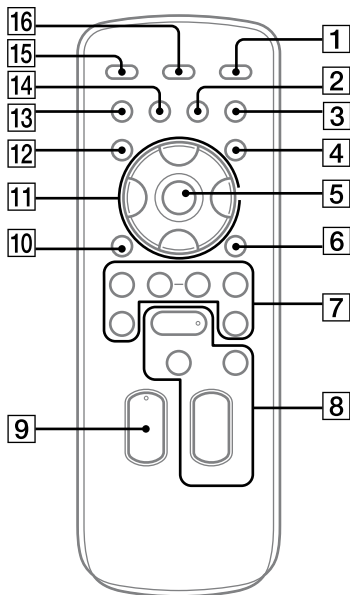
Remote**1**

I/⏻ (power) button (page 12, 27)
Press to turn on or off the system.

2

CLEAR button (page 24)
Press to delete a pre-programmed track or file.

Continued

3

EQ button (page 25)

Press to select the sound effect.

4

TIMER MENU button (page 12, 27, 28)

Press to set the clock and the Play Timer.

5

+ (enter) button (page 12, 15, 16, 19, 20, 27, 28)

Press to enter the settings.

6

TOOL MENU button (page 16)

Press to select a menu when using the iPod.

7

📁 +/- (select folder) button (page 13, 19, 20, 22, 23)

Press to select a folder.

+/- (tuning) button (page 15)

Press to tune in the desired station.

⏮️/⏭️ (go back/go forward) button (page 13, 16, 20, 22, 23)

Press to select a track or file.

⏮️/⏭️ (rewind/fast forward) button (page 13, 16, 22)

Press to find a point in a track or file.

8

Playback buttons and function buttons

▶️ (play) button (page 13, 16, 22)

Press to start playback.

⏸️ (pause) button (page 13, 16, 22)

Press to pause playback.

■ (stop) button (page 13, 15, 16, 20, 22)

Press to stop playback of a disc or optional USB device.

Press to pause playback of an iPod.

FUNCTION +/- button (page 13, 15, 16, 19, 20, 22, 23, 25)

Press to select the function.

9

VOLUME +/- button

Press to adjust the volume.

10

🔄 RETURN button (page 16)

Press to return to the previous menu when using the iPod.

11

⬆️/⬇️/⬅️/➡️ button (page 12, 16, 27, 28)

Press to select the menu items.

12**TUNER MEMORY button (page 15)**

Press to preset the radio station.

13**PLAY MODE/TUNING MODE button (page 14, 15, 22, 23, 24)**

Press to select the play mode of a disc or an optional USB device.

Press to select the tuning mode.

14**REPEAT/FM MODE button (page 13, 15, 22)**

Press to listen to a disc, a single track or file repeatedly.

Press to select the FM reception mode (monaural or stereo).

15**SLEEP button (page 27)**

Press to set the Sleep Timer.

16**DISPLAY button (page 24, 26)**

Press to change the information on the display.

Getting Started

Hooking up the system securely

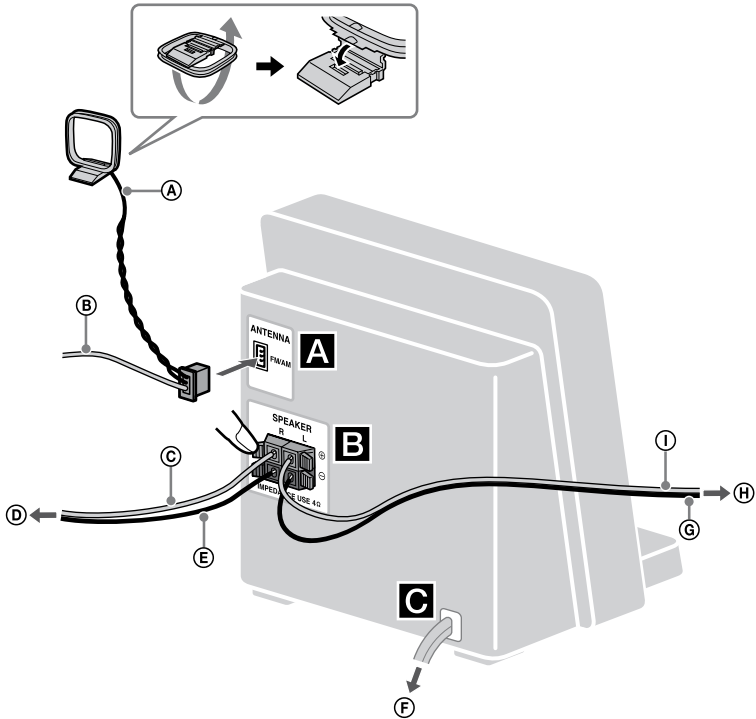

- A** AM loop antenna
- B** FM lead antenna (Extend it horizontally.)
- C** Speaker cord (Red/⊕)
- D** To right speaker
- E** Speaker cord (Black/⊖)
- F** To wall outlet
- G** Speaker cord (Black/⊖)
- H** To left speaker
- I** Speaker cord (Red/⊕)

A Antennas

Find a location and an orientation that provide good reception, and then set up the antennas.

Keep the antennas away from the speaker cords, the power cord and the USB cable to avoid picking up noise.

B Speakers

Insert only the stripped portion of the cord.

C Power

Connect the power cord to a wall outlet. If the plug does not fit the wall outlet, detach the supplied plug adaptor (only for models equipped with an adaptor).

Inserting batteries

Slide and remove the battery compartment lid, and insert the two supplied R6 (size AA) batteries, **+** side first, matching the polarities shown below.

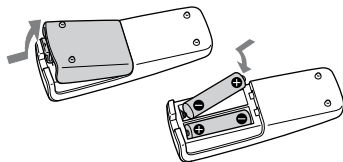
**Notes**

- With normal use, the batteries should last for about six months.
- Do not mix an old battery with a new one or mix different types of batteries.
- If you do not use the remote for a long period of time, remove the batteries to avoid damage from battery leakage and corrosion.
- Batteries installed devices shall not be exposed to excessive heat such as sunshine, fire or the like.

Using the iPod

Insert an iPod Dock Adapter into the Dock before use. The iPod Dock Adapter is not supplied with the system. Use an iPod Dock Adapter supplied with your iPod. For details on the iPod Dock Adapter, refer to the user's guide of your iPod.

To remove the iPod Dock Adapter, pull it up with your fingernail or a flat object using the slot inside the adapter.

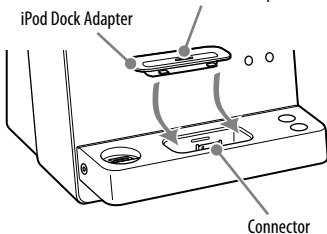

Setting the clock

Use buttons on the remote to set the clock.

- 1** Turn on the system.
Press I/⏻.
- 2** Select the clock set mode.
Press TIMER MENU.
If "PLAY SET" flashes, press ▲/▼ repeatedly to select "CLOCK," and then press ⊕.
- 3** Set the time.
Press ▲/▼ repeatedly to set the hour, and then press ⊕.
- 4** Use the same procedure to set the minutes.

Note

The clock settings are lost when you disconnect the power cord or if a power failure occurs.

To display the clock when the system is off

Press DISPLAY. The clock is displayed for about 8 seconds.

Operations

Playing a CD/MP3 disc

1 Select the CD function.
Press FUNCTION +/- repeatedly.

2 Insert a disc.
Insert a disc in the disc slot with the label side facing forward.

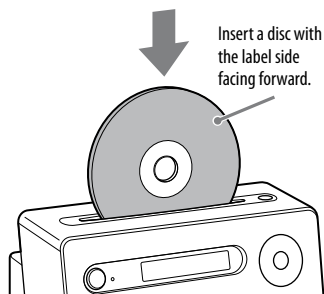

Notes

- When you turn on the system, the disc is not pulled into the disc slot until "NO DISC" appears in the display. Do not attempt to push in the disc until "NO DISC" appears.
- Do not insert a disc with non-standard shapes (e.g., heart, square, star). The disc may fall into the system and cause irreparable damage.
- When pressing ▲ on the unit and then reinserting the disc that appears in the disc slot, do not simply push in the disc. Remove the disc from the disc slot and then reinsert it.
- Do not turn off the system with a disc halfway inserted in the disc slot. Doing so may cause the disc to fall.
- Do not use a disc with tape, seals or paste on it as this may cause malfunction.
- When you eject a disc, handle the disc by its edge. Do not touch the surface.



- Do not push a disc into the disc slot when the system is off. Doing so may cause the system to malfunction.
- Do not insert an 8 cm disc with an adaptor. Doing so may cause the system to malfunction.

3 Start playback.
Press ► (or ►|| on the unit).

Other operations

To	Press
Pause playback	(or ► on the unit). To resume playback, press the button again.
Stop playback	■.
Select a folder on an MP3 disc	📁 +/- repeatedly.
Select a track or file	◀◀/▶▶.
Find a point in a track or file	Hold down ◀◀/▶▶ during playback, and release the button at the desired point.
Select Repeat Play	REPEAT repeatedly until "REP" or "REP1" appears.
Eject a disc	▲ on the unit.

To change the play mode



Press PLAY MODE repeatedly while the player is stopped. You can select normal play (“*”) for all MP3 files in the folder on the disc), shuffle play (“SHUF” or “ SHUF” for folder shuffle), or program play (“PGM”).

* When playing a CD-DA (audio) disc,  (SHUF) Play performs the same operation as normal (SHUF) Play.

Notes on Repeat Play

- All tracks or files on a disc are played repeatedly up to five times.
- “REP1” indicates that a single track or file is repeated until you stop it.

Note on shuffle play mode

When you turn off the system, the selected shuffle play mode (“SHUF” or “ SHUF”) is cleared and the play mode returns to normal play mode (“”).

Notes on playing MP3 discs

- Do not save other types of files or unnecessary folders on a disc that has MP3 files.
- Folders that have no MP3 files are skipped.
- MP3 files are played back in the order that they are recorded onto the disc.
- The system can only play MP3 files that have a file extension of “.mp3”.
- Even when file name has the “.mp3” file extension, if the actual file differs, playing this file may generate a loud noise which could damage the speaker system and the system may malfunction.

- The maximum number of:
 - folders is 150 (including the root folder).
 - MP3 files is 255.
 - MP3 files and folders that can be contained on a single disc is 256.
 - folder levels (the tree structure of files) is 8.
- Compatibility with all MP3 encoding/writing software, recording device, and recording media cannot be guaranteed. Incompatible MP3 discs may produce noise or interrupted audio or may not play at all.

Notes on playing multisession discs

- If the disc begins with a CD-DA (or MP3) session, it is recognized as a CD-DA (or MP3) disc, and playback continues until another session is encountered.
- A disc with a mixed CD format is recognized as a CD-DA disc.

Listening to the radio

- 1 Select "TUNER FM" or "TUNER AM."
Press FUNCTION +/- repeatedly.
- 2 Perform tuning.

For automatic scanning

Press TUNING MODE repeatedly until "AUTO" appears, and then press +/- (or TUNE +/- on the unit). Scanning stops automatically when a station is tuned in, and "TUNED" and "ST" (for stereo programs only) appear.

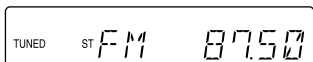

If "TUNED" does not appear and the scanning does not stop, press ■ to stop scanning, then perform manual tuning (below).

For manual tuning

Press TUNING MODE repeatedly until "MANUAL" appears, and then press +/- (or TUNE +/- on the unit) repeatedly to tune in the desired station.

Tip

To reduce static noise on a weak FM stereo station, press FM MODE repeatedly until "MONO" appears to turn off stereo reception.

Presetting a radio station

Use buttons on the remote to preset stations.

- 1 Tune in the desired station.
- 2 Press TUNER MEMORY to select the tuner memory mode.



- 3 Press +/- repeatedly to select the desired preset number.
If another station is already assigned to the selected preset number, the station is replaced by the new station.

- 4 Press ⊕ to store the station.

- 5 Repeat steps 1 through 4 to store other stations.

You can preset up to 20 FM and 10 AM stations. The preset stations are retained for about half a day even if you disconnect the power cord or if a power failure occurs.

- 6 To call up a preset radio station, press TUNING MODE repeatedly until "PRESET" appears, and then press +/- repeatedly to select the desired preset number.

Playing the iPod

You can listen to music stored in your iPod. See “Compatible iPod models with this system” (page 41) for iPod models that can be connected to this system.

- 1 Select the iPod function.
Press FUNCTION +/- repeatedly.
- 2 Place the iPod.

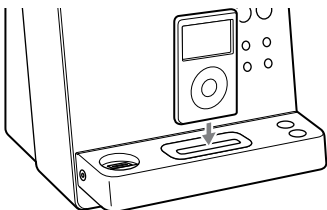

- 3 Start playback.
Press ► (or ►|| on the unit).

Other operations

You can control your iPod with the following buttons on the remote or unit.

To	Press
Pause playback	(or ► on the unit) or ■.
Scroll up/down the iPod menus	▲/▼. You can scroll up or down the iPod menus much like the Click Wheel operations of the iPod or the drag up-or-down operations of the iPod touch.
Select a track or chapter of audiobook/podcast	◀◀/▶▶. To fast-forward or fast-rewind, hold down the button.
Choose the selected item	➡/⊕ (or ENTER on the unit). You can choose the selected item much like the center button on the iPod or the touch operation of the iPod touch.
Find a point in a track or chapter of audiobook/podcast	Hold down ◀◀/▶▶ during playback, and release the button at the desired point.
Return to the previous menu or select a menu	◀/TOOL MENU/↶. You can return to the previous menu or select a menu much like the Menu button on the iPod or the touch operation of the iPod touch.

To use the system as a battery charger

You can use the system as a battery charger for the iPod when the system is on.

The charging begins when the iPod is placed on the unit's connector. The charging status appears in the iPod display. For details, see the user's guide of your iPod.

To stop charging the iPod

Remove the iPod.

Notes

- When placing or removing the iPod, handle the iPod in the same angle as that of the iPod connector on the unit and do not twist or sway the iPod to prevent connector damage.
- Do not carry the unit with an iPod set on the connector. Doing so may cause a malfunction.
- When placing or removing the iPod, brace the unit with one hand and take care not to press the controls of the iPod by mistake.
- Before disconnecting the iPod, pause playback.
- To change the volume level, use VOLUME +/- . The volume level does not change even if adjusted on the iPod.
- The iPod Dock on the unit is designed for iPod only. You cannot connect any other portable audio players.
- To use an iPod, refer to the user's guide of your iPod.
- Sony cannot accept responsibility in the event that data recorded to iPod is lost or damaged when using an iPod with this system.

Before using the USB device with this system

You can use an optional USB device with this system, connecting to the  (USB) port on the unit. Make sure you use CCC-certified USB devices.

Note on the usage of CCC-certified USB devices

Compatibility with CCC (China Compulsory Certification)-certified USB devices on this system is not fully guaranteed. This is because the USB device specifications may differ depending on the manufacturers. For more information on how to use a USB device, see the operation manual supplied with the USB device.

Notes

- When USB cable connection is necessary, connect the USB cable supplied with the USB device to be connected. See the operation manual supplied with the USB device to be connected for details on the operation method.
- It may take about 10 seconds before "READING" appears depending on the type of USB device connected.
- Do not remove the USB device during transfer or erase operations. Doing so may corrupt the data on the USB device or damage the USB device itself.
- Do not connect the system and the USB device through a USB hub.
- When the USB device is inserted, the system reads all the files on the USB device. If there are many folders or files on the USB device, it may take a long time to finish reading the USB device.

- With some connected USB devices, after an operation is performed, there may be a delay before it is performed by this system.
- Compatibility with all encoding/writing softwares, recording devices, and recording media cannot be guaranteed. Incompatible USB device may produce noise or interrupted audio or may not play at all.
- This system cannot transfer music from a disc or play audio files on the USB device in the following cases.
 - When the number of audio files in a folder exceeds 150.
 - When the number of folders on a USB device exceeds 200.

These numbers may vary depending on the file and folder structure. Do not save other types of files or unnecessary folders on a USB device that has audio files.

To use the system as a battery charger

You can use the system as a battery charger for USB devices that have a rechargeable function when the system is on.

The charging begins when the USB device is connected to the  (USB) port on the system. The charging status appears in the USB display. For details, see the user's guide of your USB device.

Note on charging the USB device with this system

You cannot use the system as a battery charger in the following cases.

- The CD player/USB device power is turned off and the tuner function is selected. See “To improve disc loading performance” (page 34).
- When the system is off.

Transferring music from a disc to a USB device

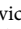
You can connect a CCC-certified USB device to the  (USB) port on the unit and transfer music from a disc to the USB device.

You can transfer music from a CD-DA disc or MP3 disc only. The audio format of files transferred by this system is MP3.

The amount of free space required on the USB device is about 1 MB per minute when transferring music from a CD.

Required free space may be larger when transferring music from an MP3 disc.

You can easily transfer all the music on a disc to a USB device (CD SYNC). You can also transfer a track or MP3 file that is currently being played back (REC1).

- 1 Connect the USB device to the  (USB) port.

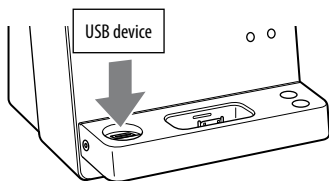

- 2 Select the CD function.
Press FUNCTION +/- repeatedly.
- 3 Insert a disc.
- 4 Set the USB device to stand by for transferring.

Synchronized transfer (CD SYNC):

Press REC TO USB on the unit.

To transfer only your favourite CD tracks or MP3 files, create your own program beforehand (see “Creating your own program” (page 23)).

To transfer only MP3 files that are stored in a specific folder on the MP3 disc, press  +/- repeatedly to select the desired folder, before starting the transfer.

REC1:

Start playback of the track or MP3 file you want to transfer, then press REC TO USB on the unit.

“REC” flashes, and the display cycles through “CD SYNC (or “REC1”),” “FREExxxM” or “FREExxxG” (free space, in megabyte or gigabyte, on the USB device) and “PUSH ENTER.”

The USB device stands by for transferring and the CD player pauses for play.

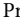
- 5 Start transferring.
Press  (or ENTER on the unit).
Transferring starts.

When using CD SYNC

When the transfer is completed, access to the USB device and the CD player stop automatically.

When using REC1

When the transfer is completed, access to the USB device stops automatically and the CD player continues playback.

To select the memory on the USB device

If the USB device has more than one memory (for example, internal memory and a memory card), you can select which memory to read to and then start transferring.

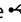
- 1 Connect the USB device to the  (USB) port.
- 2 Select the USB function.
Press FUNCTION +/- repeatedly.

- 3 Press USB MENU on the unit in stop mode.
“USB SEL” appears. If an audio file or a folder is selected, “ERASE” appears instead. Press **◀◀/▶▶** repeatedly to select “USB SEL.”
- 4 Press **⊕** (or ENTER on the unit).
The name of a memory appears.
The displayed name varies depending on the specifications of the USB device.
- 5 Press **◀◀/▶▶** repeatedly to select the memory.
Proceed to step 6 if only one memory can be selected.
To cancel this operation, press **■**.
- 6 Press **⊕** (or ENTER on the unit).
- 7 Start transferring by following steps 2 through 5 of “Transferring music from a disc to a USB device.”

To stop transferring

Press **■**.

To erase audio files or folders from the USB device

You can erase audio files or folders from the USB device. Note that you cannot erase audio files and folders in shuffle play mode or program play mode.

- 1 Connect the USB device to the **↔** (USB) port.
- 2 Select the USB function.
Press FUNCTION +/- repeatedly.
- 3 Press **◀◀/▶▶** or **📁 +/-** repeatedly to select the audio file or folder you want to erase.
- 4 Press USB MENU on the unit.
“ERASE” appears.
- 5 Press **⊕** (or ENTER on the unit).
“TRACK ERASE” or “FOLDER ERASE” appears in the display.
To cancel the erase operation, press **■**.
- 6 Press **⊕** (or ENTER on the unit).
The selected audio file or folder is erased.

Folder and file generation rules

When first transferring music to a USB device, a “MUSIC” folder is created directly below the “ROOT”

Folders and files are generated within this “MUSIC” folder as follows.

CD SYNC¹⁾

Music source	Folder name	File name
MP3	Same as the music source ²⁾	
CD-DA	“CDDA001” ³⁾	“TRACK001” ⁴⁾

REC1

Music source	Folder name	File name
MP3	“REC1” ⁵⁾	Same as the music source ²⁾
CD-DA		“TRACK001” ⁴⁾

¹⁾ In Program Play mode, the folder name is “PGM_xxx,” and the file name depends on the music source (CD-DA disc or MP3 disc).

²⁾ Up to 64 characters of the name are assigned.

³⁾ Folder numbers are assigned serially thereafter up to the maximum 999 (including the “ROOT” and “MUSIC” folders).

⁴⁾ File numbers are assigned serially thereafter.

⁵⁾ A new file is created in the “REC1” folder each time REC1 is performed.

Notes

- When transferring music from a CD, the tracks are transferred as 128 kbps MP3 files. When transferring music from an MP3 disc, MP3 files are transferred with the same bit rate as the original MP3 files.
- If you start transferring in shuffle play mode, repeat play mode or in program play mode (when no tracks or MP3 files are programmed), the selected play mode is automatically cancelled and the play mode switches to normal play mode.
- While transferring music from an MP3 disc, no sound is output and “HIGH-SPEED” appears.
- CD text information is not transferred in the created MP3 files.
- If you cancel the transfer partway, an MP3 file is created up to the point when the transfer was stopped.
- Transferring stops automatically if:
 - the USB device runs out of space during the transfer process.
 - the number of audio files on the USB device reaches the limit for the number that the system can recognize.
- If the folder to be erased contains non-MP3/WMA/AAC format files or sub folders, these are not erased.
- If a folder or file that you are trying to transfer already exists on the USB device with the same name, a sequential number is added after the name without overwriting the original folder or file.

Playing a file of the USB device

You can listen to music stored in the connected CCC-certified USB device.

The audio formats that can be played back by this system are as follows:

MP3*/WMA*/AAC*

* Files with copyright protection (Digital Rights Management) cannot be played back by this system.

Files downloaded from an online music store may not be played back by this system.

1 Select the USB function.

Press FUNCTION +/- repeatedly.

2 Connect the USB device to the (USB) port.

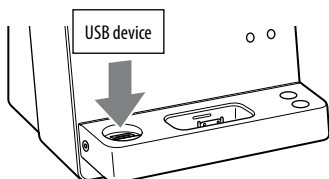







When the USB device is connected, the display changes as follows: "READING" → "STORAGE DRIVE"

* When connecting the USB device, the volume label is displayed next if recorded.

3 Start playback.

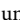
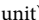
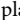

Press  (or  on the unit).

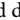
Other operations

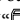

To	Press
Pause playback	 (or  on the unit). To resume play, press the button again.
Stop playback	 . To resume play, press  (or  on the unit)*. To cancel resume play, press  again.
Select a folder	 +/- repeatedly.
Select a file	 /  .
Find a point in a file	Hold down  /  during playback, and release the button at the desired point.
Select Repeat Play	REPEAT repeatedly until "REP" or "REP1" appears.

* When playing a VBR (variable bit rate) MP3/WMA file, the system may resume playback from a different point.

To change the play mode

Press PLAY MODE repeatedly while the USB device is stopped. You can select normal play ( for all files in the folder on the USB device), shuffle play ("SHUF" or  SHUF), or program play ("PGM").

Note on shuffle play mode

When you turn off the system, the selected shuffle play mode (“SHUF” or “ SHUF”) is cleared and the play mode returns to normal play mode (“”).

Notes

- The following USB device/situations can increase the time it takes to start playback:
 - a USB device recorded with a complicated tree structure.
 - the memory capacity is excessive.
- The system can play back to a depth of 8 folders only.
- This system does not necessarily support all the functions provided in a connected USB device.
- Resume play is canceled when you turn off the system.
- The playback order for the system may differ from the order of the connected USB device.
- Folders that have no audio files are skipped.
- The file formats that this system can play are as follows:
 - MP3: file extension “.mp3”
 - WMA file: file extension “.wma”
 - AAC: file extension “.m4a”

Note that even when file names have the above file extensions, if the actual files differ, playing these files may generate a loud noise which could damage the speaker system and the system may malfunction.

Creating your own program

(Program Play)

Use buttons on the remote to create your own program.

1 Select the desired function.

CD

Press FUNCTION +/- repeatedly to select the CD function.



USB

Press FUNCTION +/- repeatedly to select the USB function.

2 Select the play mode.

Press PLAY MODE repeatedly until “PGM” appears while the system is stopped.

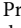
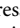
3 Select the desired track or file number.

Press   repeatedly until the desired track or file number appears. When programming MP3 files, press  +/- repeatedly to select the desired folder, and then select the desired file.

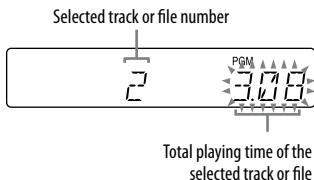

Continued 

- 4** Program the selected track or file.

Press ⊕ to enter the selected track or file.

CD

“— .— —” appears when the total program time exceeds 100 minutes for a CD or when you select an MP3 file.

USB

The total program time cannot be displayed, so “— .— —” appears.

- 5** Repeat steps 3 through 4 to program additional tracks or files, up to a total of 25 tracks or files.

- 6** To play your program of tracks or files, press ►.

The program remains available until you remove the disc or USB device.

To play the same program again, press ►.

To cancel Program Play

Press PLAY MODE repeatedly until “PGM” disappears while the system is stopped.

To delete the last track or file of the program

Press CLEAR while the system is stopped.

To view program information, such as total track number of the program

Press DISPLAY repeatedly.

Using optional audio components

- 1** Prepare the sound source.
Connect additional audio component to the AUDIO IN jack on the unit using an audio analog cord (not supplied).
- 2** Turn down the volume.
Press VOLUME —.
- 3** Select the AUDIO IN function.
Press FUNCTION +/- repeatedly.
- 4** Start playback.
Start playback of the connected component and adjust its volume.
- 5** Adjust the volume.
Press VOLUME +/-.

Adjusting the sound

To	Press
Generate a more dynamic sound (Dynamic Sound Generator X-tra)	DSGX on the unit.
Set the sound effect	EQ repeatedly.

Changing the display

To	Press
Change information on the display ¹⁾	DISPLAY repeatedly when the system is on.
Check the clock when the system is off	DISPLAY when the system is off ²⁾ . The clock is displayed for 8 seconds.

- ¹⁾ For example, you can view CD/MP3 disc information or the USB device information, such as;
- track or file number during normal play.
 - track or file name (“🎵”) during normal play.
 - artist name (“👤”) during normal play.
 - album or folder name (“📁”) during normal play.
 - total playing time while the player is stopped.
 - volume label if it exists on the disc or USB device.

- ²⁾ The STANDBY indicator on the unit lights up when the system is off.

Notes on the display information

- Characters that cannot be displayed appear as “_”.
- The following are not displayed:
 - total playing time and remaining playing time for an MP3 disc and USB device.
 - remaining playing time for an MP3 file.

- The following are not displayed correctly:
 - elapsed playing time of an MP3 file encoded using VBR (variable bit rate).
 - folder and file names that do not follow either the ISO9660 Level 1, Level 2 or Joliet in the expansion format.
- The following are displayed:
 - total playing time for a CD-DA disc during normal play.
 - remaining playing time for a track.
 - remaining playing time of a current CD-DA disc during normal play.
 - ID3 tag information for MP3 files when ID3 version 1 and version 2 tags are used (ID3 version 2 tag information display has priority when both ID3 version 1 and version 2 tags are used for a single MP3 file).
 - up to 15 characters of ID3 tag, WMA tag and AAC tag information using uppercase letters (A to Z), numbers (0 to 9), and symbols (“\$%’()*,-./<=>@[\\]_’{ } ! ? ^”).

Using the Timers

The system offers two timer functions. If you use the Play Timer with the Sleep Timer, the Sleep Timer has priority. Use buttons on the remote to use the timer functions.

Sleep Timer:

You can fall asleep to music. This function works even if the clock is not set.

Press SLEEP repeatedly.

If you select "AUTO," the system automatically turns off after the current disc or USB device stops or in 100 minutes.

Play Timer:

You can wake up to CD, tuner, iPod or optional USB device at a preset time. Make sure you have set the clock.

- 1 Prepare the sound source.**
Prepare the sound source, and then press VOLUME +/- to adjust the volume.
To start from a specific track or audio file, create your own program (page 23).
- 2 Select the timer set mode.**
Press TIMER MENU.

- 3 Set the play timer.**
Press $\blacktriangle/\blacktriangledown$ repeatedly to select "PLAY SET," and then press \oplus .
"ON TIME" appears, and the hour indication flashes.
- 4 Set the time to start playback.**
Press $\blacktriangle/\blacktriangledown$ repeatedly to set the hour, and then press \oplus . The minute indication flashes. Use the procedure above to set the minutes.
"OFF TIME" appears and the hour indication flashes in the display.
- 5 Use the same procedure as in step 4 to set the time to stop playback.**
- 6 Select the sound source.**
Press $\blacktriangle/\blacktriangledown$ repeatedly until the desired sound source appears, and then press \oplus . The display shows the timer settings.
- 7 Turn off the system.**
Press I/⏻.
The system turns on 15 seconds before the preset time. If the system is on at the preset time, the Play Timer will not be activated. Do not operate the system from the time the system turns on until the playback starts.

To check the setting

- 1 Press TIMER MENU.
“SELECT” flashes in the display.
- 2 Press ⊕.
- 3 Press ▲/▼ repeatedly to select “PLAY SEL.”
- 4 Press ⊕.

To cancel the timer

- 1 Press TIMER MENU.
“SELECT” flashes in the display.
- 2 Press ⊕.
- 3 Press ▲/▼ repeatedly to select “OFF.”
- 4 Press ⊕.

To change the setting

Start over from step 1.

Notes for the iPod user

- Make sure the iPod is not playing when using the Play Timer.
- The Play Timer may not be activated depending on the status of the connected iPod.

Tip

The Play Timer setting remains as long as the setting is not canceled manually.

Additional Information

Troubleshooting

- 1 Make sure the power cord and speaker cords are correctly and firmly connected.
- 2 Find your problem in the checklist below, and take the indicated corrective action.
If the issue persists, contact your nearest Sony dealer.

If the STANDBY indicator flashes

Immediately unplug the power cord, and check the following items.

- If your system has a voltage selector, is the voltage selector set to the correct voltage?
- Are you using only the supplied speakers?
- Is anything blocking the ventilation holes on the top or back of the system?
- Is the iPod connector short-circuited?

After the STANDBY indicator stops flashing, reconnect the power cord, and turn on the system. If the issue persists, contact your nearest Sony dealer.

General

The system does not turn on.

- Is the power cord plugged in?

There is no sound.

- Are the + and - speaker cords short-circuited?
- Are you using only the supplied speakers?
- Is anything blocking the ventilation holes on the top or back of the system?

- The specified station may have temporarily stopped broadcast.

The STANDBY indicator remains lit after unplugging the power cord.

- The STANDBY indicator may not turn off immediately after unplugging the power cord. This is not a malfunction. The indicator will turn off after about 40 seconds.

Sound comes from one channel, or the left and right volumes are unbalanced.

- Place the speakers as symmetrically as possible.
- Connect only the supplied speakers.

Severe hum or noise.

- Move the system away from sources of noise.
- Connect the system to a different wall outlet.
- Install a noise filter (available separately) to the power cord.

The remote does not function.

- Remove any obstacles between the remote and the remote sensor on the unit, and position the unit away from fluorescent lights.
- Point the remote at the system's sensor.
- Move the remote closer to the system.

CD/MP3 player

The sound skips, or the disc will not play.

- Wipe the disc clean, and replace it.
- Move the system to a location away from vibration (for example, on top of a stable stand).
- Move the speakers away from the system, or place them on separate stands. At high volume, speaker vibration may cause the sound to skip.

Play does not start from the first track.

- Return to Normal Play by pressing PLAY MODE repeatedly until both "PGM" and "SHUF" disappear.

Starting playback takes more time than usual.

- The following discs can increase the time it takes to start playback.
 - A disc recorded with a complicated tree structure
 - A disc recorded in multisession mode
 - A disc that has not been finalized (a disc to which data can be added)
 - A disc that has many folders

The system does not eject the disc and "LOCKED" appears.

- Contact your Sony dealer or local authorized Sony service facility.

iPod

There is no sound.

- Make sure the iPod is connected securely.
- Make sure the iPod is playing music.
- Adjust the volume.

The sound is distorted.

- Turn down the volume.
- Set the "EQ" setting of the iPod to "Off" or "Flat."

The remote does not function.

- Make sure the iPod is updated with the latest software. If not, update the iPod before using with the system.

The iPod cannot be charged.

- Make sure the iPod is connected securely.
- You can use the system as a battery charger for iPod only when the system is on.

"OVER CURRENT" appears.

- A problem has been detected with the level of electrical current from the iPod connector. Turn off the system and remove the iPod from the iPod connector. Make sure there is no problem with the iPod. If this display pattern persists, contact your nearest Sony dealer.

USB device

The connected USB device cannot be charged.

- Select a function other than tuner function or turn on the CD player/USB device power. See “To improve disc loading performance” (page 34).

The connected iPod is being charged but the USB device is not, when both are connected at the same time.

- Select a function other than tuner function or turn on the CD player/USB device power. See “To improve disc loading performance” (page 34).

You cannot start transferring to a USB device.

- The following problems may have occurred.
 - The USB device is full.
 - The number of files and folders on the USB device has reached the upper limit.
 - The USB device is write-protected.

Transferring is stopped before it is finished.

- You are using an unsupported USB device.
- The USB device is not formatted correctly. Refer to the USB device operation manual for how to format.
- Turn off the system and remove the USB device. If the USB device has a power switch, turn the USB device off and then on again after removing it from the system. Then perform transferring again.

- If the transfer and erase operations are repeated multiple times, the file structure within the USB device becomes fragmented. Refer to the USB device operation manual for how to deal with this problem. If the problem persists, contact your nearest Sony dealer.

Transferring music to a USB device results in an error.

- You are using an unsupported USB device.
- Turn off the system and remove the USB device. If the USB device has a power switch, turn the USB device off and then on again after removing it from the system. Then perform transferring again.
- The USB device was disconnected or the power was turned off during the transfer process. Delete the partially-transferred file, and perform transferring again. If this does not fix the problem, the USB device may be broken. Refer to the USB device operation manual for how to deal with this problem. If the problem persists, contact your nearest Sony dealer.



Files or folders on the USB device cannot be erased.

- Check if the USB device is write-protected.
- The USB device was disconnected or the power was turned off during the erase operation. Delete the partially-erased file. If this does not fix the problem, the USB device may be broken. Refer to the USB device operation manual for how to deal with this problem. If the problem persists, contact your nearest Sony dealer.

Are you using a supported USB device?

- If you connect an unsupported USB device, the following problems may occur.
 - The USB device is not recognized.
 - File or folder names are not displayed on this system.
 - Playback is not possible.
 - The sound skips.
 - There is noise.
 - A distorted sound is output.
 - Transferring stops before it is finished.

“OVER CURRENT” appears.

- A problem has been detected with the level of electrical current from the  (USB) port. Turn off the system and remove the USB device from the  (USB) port. Make sure there is no problem with the USB device. If this display pattern persists, contact your nearest Sony dealer.

There is no sound.

- The USB device is not connected correctly. Turn off the system, then reconnect the USB device.

There is noise, skipping, or distorted sound.

- Turn off the system, then reconnect the USB device.
- The music data itself contains noise, or the sound is distorted. Noise may have entered during the transfer process. Delete the file, and try transferring again.

The USB device cannot be connected into the (USB) port.

- The USB device is being connected backwards. Connect the USB device in the correct orientation.

“READING” is displayed for an extended time, or it takes a long time before playback starts.

- The reading process can take a long time in the following cases.
 - There are many folders or files on the USB device.
 - The file structure is extremely complex.
 - The memory capacity is excessive.
 - The internal memory is fragmented.Thus, we recommend following these guidelines.
 - Total folders on USB device: 100 or less
 - Total files per folder: 100 or less

Erroneous display

- Send the music data to the USB device again, as the data stored in the USB device may have been corrupted.
- The character codes that can be displayed by this system are numbers and alphabet only. Other characters are not displayed correctly.

The USB device is not recognized.

- Turn off the system and reconnect the USB device, then turn on the system.
- The USB device does not work properly. Refer to the USB device operation manual for how to deal with this problem. If the problem persists, contact your nearest Sony dealer.

Play does not start.

- Turn off the system and reconnect the USB device, then turn on the system.
- Press ► (or ►|| on the unit) to start playback.

Play does not start from the first track.

- Set the play mode to Normal Play mode.

Files cannot be played back.

- The audio file does not have the extension “.mp3”, “.wma” or “.m4a”.
- The data is not stored in MP3/WMA/AAC format.
- USB storage device formatted with file systems other than FAT16 or FAT32 are unsupported.*
- If you use a partitioned USB storage device, only files on the first partition can be played.
- Playback is possible up to 8 levels.
- The number of folders has exceeded 999.
- The number of files has exceeded 999.
- Files that are encrypted or protected by passwords, etc. cannot be played back.

* This system supports FAT16 and FAT32, but some USB storage devices may not support all of these FAT. For details, see the operation manual of each USB storage device or contact the manufacturer.

Tuner**Severe hum or noise, or stations cannot be received. (“TUNED” or “ST” flashes on the display.)**

- Connect the antenna properly.
- Find a location and an orientation that provide good reception, and then set up the antenna again.
- Keep the antennas away from the speaker cords, the power cord and the USB cable to avoid picking up noise.
- Turn off nearby electrical equipment.

Several radio stations can be heard at the same time.

- Find a location and an orientation that provide good reception, and then set up the antenna again.
- Bundle the antenna cables using commercially available cord clips, for example, and adjust the cable lengths.

Continued 

To change the AM tuning interval

The AM tuning interval is factory-preset to 9 kHz (or 10 kHz, for some areas). Use buttons on the unit to change the AM tuning interval.

- 1 Tune in any AM station, and then turn off the system.
- 2 Press DISPLAY to display the clock.
- 3 While holding down ►►, press I/⏻. All the AM preset stations are erased. To reset the interval to the factory preset, repeat the procedure.

To improve disc loading performance

Turn on the CD player/USB device power using the CD/USB power management function. By default, the CD player/USB device power is turned off.

Use buttons on the unit to turn on the CD player/USB device power.

- 1 Press FUNCTION +/- repeatedly to select the CD function.
- 2 Press I/⏻ to turn off the system.
- 3 After "STANDBY" stops flashing, press DISPLAY to display the clock and then press I/⏻ while holding down ■.
"CD/USB PWR ON" appears. Turning the CD player/USB device power on, decreases disc access time and improves loading performance. If there is poor tuner reception when the CD player/USB device power is turned on, return the setting to default.
To turn off the CD player/USB device power, repeat the procedure until "CD/USB PWR OFF" appears.

Note that when the tuner function is selected when turning off the CD player/USB device power, power is not supplied to the USB device, and the device is therefore not recognized and not charged by the system, even if connected.

To reset the system to factory settings

If the system still does not operate properly, reset the system to factory settings.

Use buttons on the unit to reset the unit to its factory default settings.

- 1 Disconnect and reconnect the power cord, and then turn on the system.
- 2 Hold down ■ and ENTER, and press I/⏻.
All user-configured settings, such as preset radio stations, timer, and the clock, are deleted.

Messages

One of the following messages may appear or flash in the front panel display during operation.

CANNOT PLAY

You tried to play an unsupported file on the USB device.

COMPLETE

- The radio preset operation ended normally.
- The audio file or folder on the USB device has been erased.

DATA ERROR

You tried to play an unplayable file on the USB device.

DEVICE ERROR

The USB device could not be recognized or an unknown device is connected (page 32, 33).

DEVICE FULL

The USB device is full.

ERASE ERROR

Erase of audio files or folders on the USB device failed.

ERROR

- The USB device could not be recognized or an unknown device is connected (page 32, 33).
- Unknown trouble has occurred to the connected USB device when starting playback.

FATAL ERROR

The USB device has been disconnected while transferring, or erasing audio files or folders on the USB device.

FOLDER FULL

The number of folders on the USB device has reached the maximum.

FULL

You tried to program more than 25 tracks or files (steps).

LOCKED

The system does not eject the disc. Contact your nearest Sony dealer.

NoDEVICE

No USB device is connected or the connected USB device has been stopped.

NO DISC

There is no disc in the player, or you have loaded a disc that cannot be played.

NO STEP

All of the programmed tracks or files have been erased.

NO TRACK

Playable file on the USB device is not loaded in the system.

NOT USED

You tried to perform a specific operation under conditions where that operation is prohibited.

NO SUPPORT

An unsupported USB device is connected.

OVER

You have reached the end of the disc while pressing ►► during playback or pause.

PROTECTED

You tried to perform transferring or erase operation against a write-protected USB device.

PUSH STOP

- You have pressed PLAY MODE during playback.
- You have pressed the buttons whose operation is only possible when playback is stopped.

READING

- The system is reading information of the disc. Some buttons are not available.
- The system is recognizing the USB device.

REC ERROR

Transferring did not start, stopped partway, or otherwise could not be performed (page 31).

REMOVED

The USB device has been removed.

STORAGE DRIVE

A USB device is connected.

TIME NG

The Play Timer start and end times are set to the same time.

TRACK FULL

The number of files on the USB device has reached the maximum.

Display examples

Display	indicates
2	2 (two)
5	5 (five)
6	6 (six)
8	8 (eight)
0	0 (zero)
A	A
B	B
D	D
G	G
H	H
K	K
M	M
O	O
Q	Q
R	R
S	S
Z	Z
	! or
"	"
\$	\$
%	%
,	,
.	.
?	?
@	@
^	^

Precautions

Discs that this system CAN play

- Audio CD
- CD-R/CD-RW (audio data/MP3 files)

Discs that this system CANNOT play

- CD-ROM
- CD-R/CD-RW other than those recorded in music CD format or MP3 format conforming to ISO9660 Level 1/Level 2, Joliet
- CD-R/CD-RW recorded in multisession that have not ended by "closing the session"
- CD-R/CD-RW of poor recording quality, CD-R/CD-RW that have scratches or are dirty, or CD-R/CD-RW recorded with an incompatible recording device
- CD-R/CD-RW which is finalized incorrectly
- Discs containing files other than MPEG 1 Audio Layer-3 (MP3) files
- Discs of non-standard shape (for example, heart, square, star)
- Discs that have adhesive tape, paper, or sticker attached to them
- Rental or used discs with attached seals where the glue extends beyond the seal
- Discs that have labels printed using ink that feels tacky when touched

Continued 

Notes on discs

- Before playing, wipe the disc with a cleaning cloth from the centre out to the edge.
- Do not clean discs with solvents, such as benzene, thinner, or commercially available cleaners or anti-static spray intended for vinyl LPs.
- Do not expose discs to direct sunlight or heat sources such as hot air ducts, nor leave it in a car parked in direct sunlight.

On safety

- Completely disconnect the power cord (mains lead) from the wall outlet (mains) if it is not going to be used for an extended period of time. When unplugging the unit, always grip the plug. Never pull the cord itself.
- Should any solid object or liquid get into the system, unplug the system, and have it checked by qualified personnel before operating it again.
- AC power cord must be changed only at the qualified service shop.

On placement

- Do not place the system in an inclined position or in locations that are extremely hot, cold, dusty, dirty, or humid or lacking adequate ventilation, or subject to vibration, direct sunlight or a bright light.
- Be careful when placing the unit or speakers on surfaces that have been specially treated (for example, with wax, oil, polish) as staining or discoloration of the surface may result.

- If the system is brought directly from a cold to a warm location or is placed in a very damp room, moisture may condense on the lens inside the CD player, and cause the system to malfunction. In this situation, remove the disc, and leave the system turned on for about an hour until the moisture evaporates.

On heat buildup

- Heat buildup on the unit during operation is normal and is not cause for alarm.
- Do not touch the cabinet if it has been used continuously at a high volume because the cabinet may become hot.
- Do not obstruct the ventilation holes.

On the speaker system

This speaker system is not magnetically shielded, and the picture on nearby TV sets may become magnetically distorted. In this situation, turn off the TV, wait 15 to 30 minutes, and turn it back on. If there is no improvement, move the speakers far away from the TV.

Cleaning the cabinet

Clean this system with a soft cloth slightly moistened with a mild detergent solution. Do not use any type of abrasive pad, scouring powder, or solvent, such as thinner, benzene, or alcohol.

Specifications

Main unit

Amplifier section

- DIN power output (rated):
2 + 2 watts (4 ohms at 1 kHz, DIN)
- Continuous RMS power output (reference):
3 + 3 watts (4 ohms at 1 kHz, 10% THD)

Inputs

- AUDIO IN (stereo mini jack):
Impedance 22 kilohms

Outputs

- PHONES (stereo mini jack):
accepts headphones with an impedance of 8 ohms or more
- SPEAKER: accepts impedance of 4 ohms

USB section

- Supported bit rate:
MP3 (MPEG 1 Audio Layer-3):
32 – 320 kbps, VBR
WMA: 32 – 192 kbps, VBR
AAC: 48 – 320 kbps
- Sampling frequencies:
MP3 (MPEG 1 Audio Layer-3):
32/44.1/48 kHz
WMA: 44.1 kHz
AAC: 44.1 kHz
- ➔ (USB) port:
Maximum current:
500 mA

CD player section

- System:
Compact disc and digital audio system
- Laser Diode Properties
Emission Duration: Continuous
Laser Output*: Less than 44.6μW
*This output is the value measurement at a distance of 200mm from the objective lens surface on the Optical Pick-up Block with 7mm aperture.

Tuner section

- FM stereo, FM/AM superheterodyne tuner

FM tuner section:

- Tuning range:
87.5 – 108.0 MHz (50 kHz step)
- Antenna: FM lead antenna
- Intermediate frequency: 10.7 MHz

AM tuner section:

- Tuning range:
531 – 1,602 kHz (9 kHz step)
530 – 1,610 kHz (10 kHz step)
- Antenna: AM loop antenna
- Intermediate frequency: 450 kHz

Speaker

- Speaker system:
Full-range, bass-reflex, 80 mm, cone type
- Rated impedance: 4 ohms
- Dimensions (w/h/d):
Approx. 130 × 221 × 135 mm
- Mass: Approx. 0.7 kg net per speaker

General

Power requirements:

220 V AC, 50/60 Hz

Power consumption: 28 watts

Dimensions (w/h/d) (excl. speakers):

Approx. 200 × 221 × 205 mm

Mass (excl. speakers): Approx. 2.2 kg

Supplied accessories: Remote Commander (1), R6 (Size AA) batteries (2), FM lead/AM loop antenna (1)

Design and specifications are subject to change without notice.

Halogenated flame retardants are not used in the certain printed wiring boards.

Please contact the following to obtain customer support for this system.

Sony China Customer Support Center

TEL: 400-810-9000

<http://www.sony.com.cn/>

Compatible iPod models with this system

You can use the following iPod models on this system. Update your iPod with the latest software before using it.



iPod touch 2nd generation



iPod nano 4th generation (video)



iPod touch 1st generation



iPod nano 3rd generation (video)



iPod classic



iPod nano 2nd generation (aluminum)



iPod 5th generation (video)



iPod nano 1st generation



iPod 4th generation (color display)



iPod 4th generation



iPod mini

注意

为了减少火灾危险，请勿用报纸、桌布、窗帘等覆盖本装置的通风口。请勿将明火源（如点燃的蜡烛）放在本装置上。

为了减少火灾或触电的危险，请勿将本装置暴露于滴水或溅水中，并不要把装有液体的物品（如花瓶）放在本装置上。

请勿将本机安放在书橱或壁橱等狭窄封闭处。

由于电源插头用于断开主机与电源的连接，请将主机连接到容易插拔的交流电源插座上。如果发现主机发生异常，请立即将电源插头从交流电源插座上拔下。

请勿将电池或装有电池的装置暴露在阳光、火焰或类似的过热热源附近。

警告

与光学仪器一起使用本产品将会增加眼睛受伤的危险。

美国和加拿大的用户除外



本装置属于1类激光（CLASS 1 LASER）产品。本标签位于背面外壳上。

制造商：索尼公司

原产地：中国

总经销商：索尼（中国）有限公司

地址：北京市朝阳区东三环北路霞光里18号佳程大厦A座25层

出版日期：2010年8月

有关DualDisc的注意事项

DualDisc是一种双面光盘产品，它一面含有符合录制DVD的素材，另一面为数字音频素材。但是，由于音频素材一面不符合Compact Disc（CD）标准，无法保证在本产品上播放。

用版权保护技术编码的音乐光盘

本产品被设计用于播放符合Compact Disc（CD）标准的光盘。近来，一些唱片公司在出售各种用版权保护技术编码的音乐光盘。请注意，这些光盘中有一些光盘不符合CD标准而可能无法用本产品播放。

有关版权保护内容的注意事项

传输的音乐仅限个人使用。音乐的使用方法超越该限制时，需要获得版权持有者的许可。

许可和商标须知

- iPod是Apple Inc.在美国和其他国家注册的商标。
- MPEG Layer-3音频编码技术和专利由Fraunhofer IIS和Thomson授权。
- Windows Media是Microsoft Corporation在美国和/或其他国家的注册商标。



产品中有毒有害物质或元素的名称及含量

(○：不含有，×：含有)

部件名称	有毒有害物质或元素					
	铅 (Pb)	汞 (Hg)	镉 (Cd)	六价铬 (Cr (VI))	多溴联苯 (PBB)	多溴二苯醚 (PBDE)
内置线路板	×	○	○	○	○	○
外壳	×	○	○	○	○	○
光学块	×	○	○	○	○	○
驱动单元	×	○	○	○	○	○
扬声器	×	○	○	○	○	○
附件	×	○	○	○	○	○

○：表示该有毒有害物质在该部件所有均质材料中的含量均在SJ/T11363-2006标准规定的限量要求以下。

×：表示该有毒有害物质至少在该部件的某一均质材料中的含量超出SJ/T11363-2006标准规定的限量要求。

目录

部件和控制指南.....	5
--------------	---

使用前的准备工作

牢固地连接系统.....	10
设定时钟.....	12

操作

播放CD/MP3光盘.....	13
收听广播.....	15
播放iPod.....	16
在本系统上使用USB 设备之前.....	17
从光盘向USB设备传输音乐....	18
播放USB设备的文件.....	22
创建您自己的程序 (编程播放).....	23
使用选购音频组件.....	25
调节音质.....	25
改变显示.....	26
使用定时器.....	27

补充信息

故障排除.....	29
讯息.....	35
使用须知.....	37
规格.....	39
与本系统兼容的iPod机型.....	41

部件和控制指南

本手册主要说明使用遥控器的操作，但使用主机上具有相同或相似名称的按钮也可以进行相同的操作。

主机

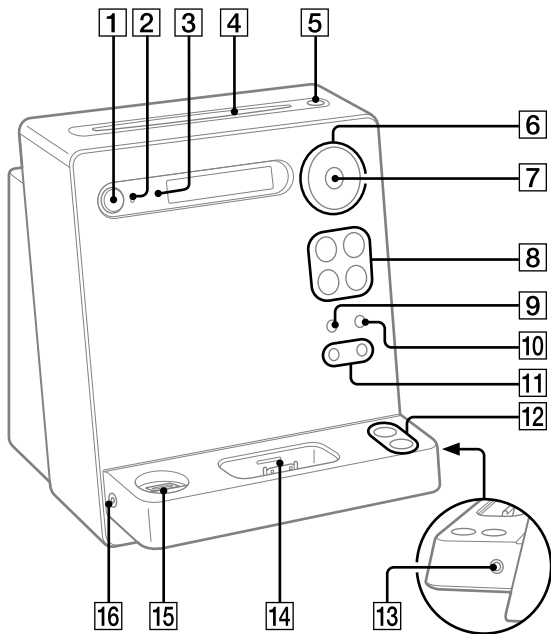

接下页 

1
I/⏻ (电源) 按钮 (第12、27页)

按下以打开或关闭系统。

2
STANDBY指示灯 (第26、29页)

当系统电源关闭时点亮。

3
遥控传感器 (第30页)

4
光盘插槽

5
▲ (退出) 按钮
按下以退出光盘。

6
📁 +/- (选择文件夹) 按钮
(第13、19、20、22、23页)
按下以选择文件夹。

TUNE +/- (调谐) 按钮
(第15页)
按下以调入想要的电台。

⏮/⏭ (后退/前进) 按钮
(第13、16、20、22、23页)
按下以选择曲目或文件。

⏪/⏩ (快倒/快进) 按钮
(第13、16、22页)
按下以找到曲目或文件中的一点。

7
ENTER按钮 (第12、15、16、19、20、27、28页)
按下以输入设置。

8
播放按钮和功能按钮
▶⏸ (播放/暂停) 按钮
(第13、16、22页)
按下以开始或暂停光盘、选购USB设备或iPod的播放。

■ (停止) 按钮 (第13、15、16、20、22页)
按下以停止光盘或选购USB设备的播放。
按下以暂停iPod的播放。

FUNCTION +/- 按钮 (第13、15、16、19、20、22、23、25页)
按下以选择功能。

9
USB MENU按钮 (第20页)
按下以从连接的选购USB设备上删除音频文件和文件夹。
如果USB设备具有一个以上的存储器，按下以选择要读入的存储器。

10

REC TO USB按钮 (第19页)

按下以从光盘向连接的选购USB设备传输音乐。

11

音质按钮**EQ按钮 (第25页)****DSGX按钮 (第25页)**

按下以选择声音效果。

12

VOLUME +/-按钮

按下以调节音量。

13

AUDIO IN插孔

连接选购音频组件。

14

iPod基座 (第11页)

将iPod放在iPod基座上以收听存储在iPod中的音频内容。

15

↔ (USB) 端口 (第18、19、20、22页)

连接选购USB设备。

16

PHONES插孔

连接耳机。

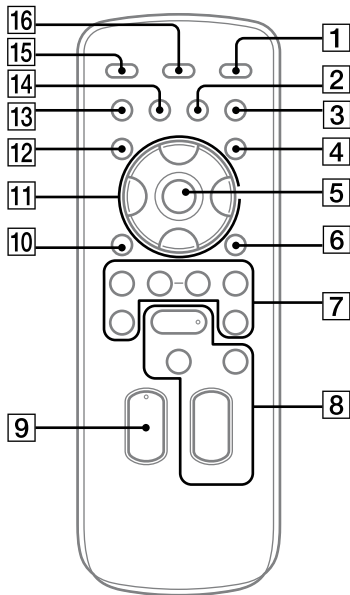
遥控器

1

I/⏻ (电源) 按钮 (第12、27页)

按下以打开或关闭系统。

2

CLEAR按钮 (第24页)

按下以删除预先编程的曲目或文件。

接下页 

3

EQ按钮 (第25页)

按下以选择声音效果。

4

TIMER MENU按钮 (第12、27、28页)

按下以设置时钟和播放定时器。

5

⊕ (输入) 按钮 (第12、15、16、19、20、27、28页)

按下以输入设置。

6

TOOL MENU按钮 (第16页)

当使用 iPod 时，按下以选择菜单。

7

📁 +/- (选择文件夹) 按钮 (第13、19、20、22、23页)

按下以选择文件夹。

+/- (调谐) 按钮 (第15页)

按下以调入想要的电台。

⏮/⏭ (后退/前进) 按钮 (第13、16、20、22、23页)

按下以选择曲目或文件。

⏪/⏩ (快倒/快进) 按钮 (第13、16、22页)

按下以找到曲目或文件中的一点。

8

播放按钮和功能按钮

▶ (播放) 按钮 (第13、16、22页)

按下以开始播放。

⏸ (暂停) 按钮 (第13、16、22页)

按下以暂停播放。

■ (停止) 按钮 (第13、15、16、20、22页)

按下以停止光盘或选购USB设备的播放。

按下以暂停 iPod 的播放。

FUNCTION +/- 按钮 (第13、15、16、19、20、22、23、25页)

按下以选择功能。

9

VOLUME +/- 按钮

按下以调节音量。

10

↶ ↷ RETURN按钮 (第16页)

当使用 iPod 时，按下以返回上一个菜单。

11

▲/▼/◀/▶ 按钮 (第12、16、27、28页)

按下以选择菜单项目。

12

TUNER MEMORY按钮（第15页）

按下以预设广播电台。

13

**PLAY MODE/TUNING MODE按钮
（第14、15、22、23、24页）**

按下以选择光盘或选购USB设备的播放模式。

按下以选择调谐模式。

14

**REPEAT/FM MODE按钮（第13、
15、22页）**

按下以反复收听光盘、单个曲目或文件。

按下以选择FM接收模式（单声道或立体声）。

15

SLEEP按钮（第27页）

按下以设置入睡定时器。

16

DISPLAY按钮（第24、26页）

按下以改变显示窗上的信息。

使用前的准备工作

牢固地连接系统

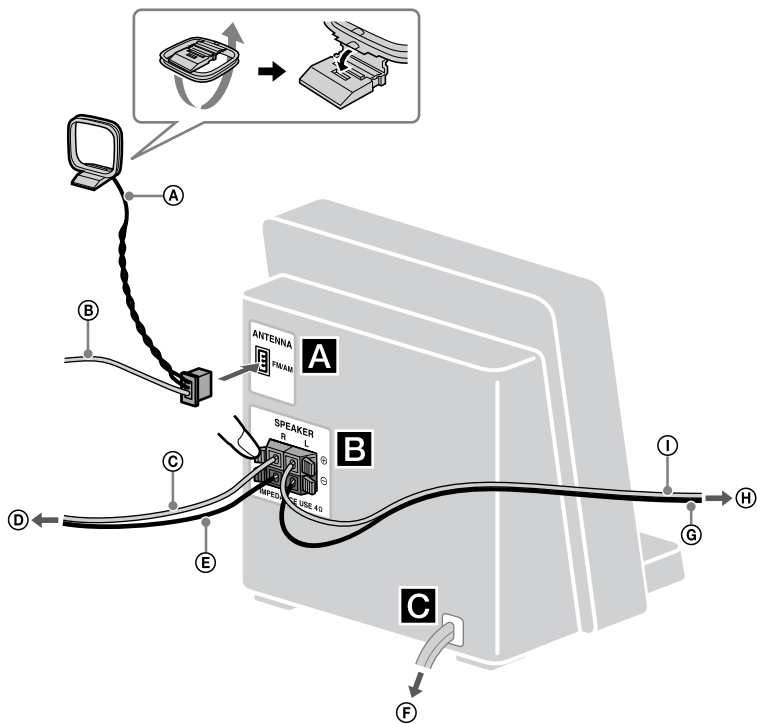

- Ⓐ AM环形天线
- Ⓑ FM导线天线 (将其水平延伸。)
- Ⓒ 扬声器导线 (红色/⊕)
- Ⓓ 至右扬声器
- Ⓔ 扬声器导线 (黑色/⊖)

- Ⓕ 至墙上电源插座
- Ⓖ 扬声器导线 (黑色/⊖)
- Ⓗ 至左扬声器
- Ⓘ 扬声器导线 (红色/⊕)

A 天线

寻找接收效果良好的场所和方向，然后设置天线。

令天线远离扬声器导线、电源线和USB电缆，以避免受到噪音干扰。

B 扬声器

仅可插入导线的裸露部分。

C 电源

连接电源线至墙上电源插座。如果插头不适合墙上电源插座，请拔下自带的插头适配器（仅限于装备有适配器的机型）。

插入电池

滑动并取下电池舱盖，然后插入附带的两节R6（AA尺寸）电池，先插入●侧，使极性与下图所示一致。

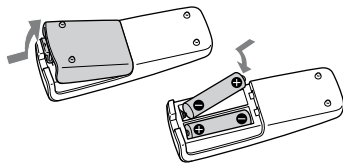
**注意**

- 通常使用情况下，电池可以使用大约6个月。
- 不要将新旧电池或不同类型的电池混合使用。
- 如果长时间不使用遥控器，请将电池取出，以避免电池漏液和腐蚀可能造成的损害。
- 请勿将装有电池的设备暴露在阳光、火焰或类似的过热源附近。

使用 iPod

使用前请将 iPod 基座适配器插入基座。本系统不附带 iPod 基座适配器。使用随 iPod 附带的 iPod 基座适配器。有关 iPod 基座适配器的详细说明，请参阅 iPod 的用户指南。

要拆下 iPod 基座适配器时，把手指甲或扁平物体插入适配器内侧的凹槽将其拉起。

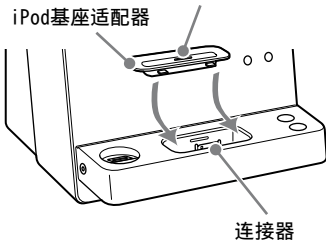

设定时钟

使用遥控器上的按钮设定时钟。

1 打开系统电源。

按I/⏻。

2 选择时钟设定模式。

按TIMER MENU。

如果“PLAY SET”闪烁，反复按
▲/▼选择“CLOCK”，然后按⊕。

3 设定时间。

反复按▲/▼设定小时，然后按
⊕。

4 进行相同操作设定分钟。

注意

当您拔下电源线或发生停电时，时钟设置会丢失。

要在系统关闭时显示时钟

按DISPLAY。时钟会显示约8秒钟。

操作

播放CD/MP3光盘

1 选择CD功能。

反复按FUNCTION +/-。

2 插入光盘。

将光盘标签面朝前插入光盘插槽。

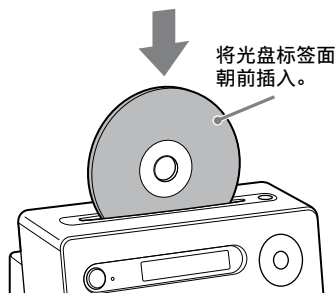

注意

- 当您打开系统电源时，到显示窗中出现“NO DISC”为止，光盘不会被拉入光盘插槽。到出现“NO DISC”为止，请勿试图推入光盘。
- 请勿插入非标准形状的光盘（例如：心形、方形、星形）。光盘可能会掉进系统并导致无法修复的损坏。
- 当按主机上的▲后要光盘插槽中出现的光盘重新插入时，请勿直接按入光盘。将光盘从光盘插槽中取出，然后重新插入。
- 请勿在光盘插入光盘插槽一半的状态下关闭系统。这样做可能会导致光盘掉落。
- 请勿使用贴有胶带、封条或黏胶的光盘，这可能会引起故障。
- 当退出光盘时，请握持光盘的边缘部分。请勿触摸表面。

- 当系统关闭时，请勿将光盘推入光盘插槽。这样做可能会导致系统故障。
- 请勿插入带有适配器的8 cm光盘。这样做可能会导致系统故障。

3 开始播放。

按▶（或主机上的▶||）。

其它操作

要	按
暂停播放	（或主机上的▶ ）。要恢复播放时，再次按该按钮。
停止播放	■。
选择MP3光盘上的文件夹	反复按📁 +/-。
选择曲目或文件	◀◀/▶▶。
寻找曲目或文件中的一段	在播放期间按住◀◀/▶▶，然后在想要的位置释放该按钮。
选择反复播放	反复按REPEAT直到出现“REP”或“REP1”。
退出光盘	主机上的▲。

要改变播放模式时

在播放机停止播放时，反复按PLAY MODE。可以选择正常播放（“▶”用于播放光盘上的文件夹中的所有MP3文件）、任选播放（“SHUF”或“▶ SHUF”用于文件夹任选播放）或编程播放（“PGM”）。

* 当播放CD-DA（音频）光盘时，▶（SHUF）播放执行与正常（SHUF）播放相同的操作。

有关反复播放的注意事项

- 最多可反复播放5次光盘上的全部曲目或文件。
- “REP1”表示反复播放单一曲目或文件，直到您停止播放为止。

有关任选播放模式的注意事项

当关闭系统的电源时，所任选播放模式（“SHUF”或“▶ SHUF”）被清除，播放模式返回到正常播放模式（“▶”）。

有关播放MP3光盘的注意事项

- 不要在含有MP3文件的光盘上保存其它类型的文件或多余的文件夹。
- 不含有MP3文件的文件夹将被略过。
- MP3文件以其在光盘上录制的顺序播放。
- 本系统只能播放具有“.mp3”文件扩展名的MP3文件。
- 即使文件名具有“.mp3”文件扩展名，如果实际文件不同，播放该文件可能会产生损坏扬声器系统的强大噪音并且系统可能会发生故障。

• 最大数目：

- 150个文件夹（包括根文件夹在内）。
- 255个MP3文件。
- 单张光盘可包含的MP3文件和文件夹的总数为256。
- 8个文件夹级别（文件的树状结构）。

- 不保证与所有MP3编码/写入软件、录制设备以及录制媒体兼容。不兼容的MP3光盘可能会发出噪音或发生音频中断或可能根本无法播放。

有关播放多区段光盘的注意事项

- 如果光盘从CD-DA（或MP3）区段开始，会被识别为CD-DA（或MP3）光盘，且播放持续到遇到另一个区段为止。
- 采用混合CD格式的光盘会被识别为CD-DA光盘。

收听广播

1 选择“TUNER FM”或“TUNER AM”。

反复按FUNCTION +/-。

2 执行调谐。

对于自动扫描

反复按TUNING MODE直到出现“AUTO”，然后按+/-（或主机上的TUNE +/-）。当调到电台时扫描自动停止，并出现“TUNED”和“ST”（仅限于立体声节目）。

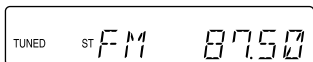

如果不出现“TUNED”或者扫描不停止，按■停止扫描，然后执行手动调谐（下述）。

对于手动调谐

反复按TUNING MODE直到出现“MANUAL”，然后反复按+/-（或主机上的TUNE +/-）调入想要的电台。

提示

要减少信号微弱的FM立体声电台的静电噪音时，反复按FM MODE直到出现“MONO”以关闭立体声接收。

预设广播电台

使用遥控器上的按钮预设电台。

1 调入希望的电台。

2 按TUNER MEMORY选择调谐器存储模式。

预设号码



3 反复按+/-选择想要的预设号码。

如果所选预设号码已被其它电台使用，已存在的电台会被新电台替换。

4 按⊕存储电台。

5 重复步骤1至4存储其它电台。

最多可以预设20个FM电台和10个AM电台。即使拔下电源线或发生停电，预设电台仍然会被保留大约半天时间。

6 要叫出预设电台时，反复按TUNING MODE直到出现“PRESET”，然后反复按+/-选择想要的预设号码。

播放 iPod

可以收听存储在 iPod 中的音乐。有关能够与本系统连接的 iPod 机型，请参见“与本系统兼容的 iPod 机型”（第41页）。

1 选择 iPod 功能。

反复按 FUNCTION +/-。

2 放置 iPod。

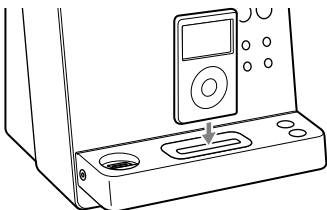

3 开始播放。

按 **▶**（或主机上的 **▶||**）。

其它操作

可以用遥控器或主机上的下列按钮控制 iPod。

要	按
暂停播放	 （或主机上的 ▶ ）或 ■ 。
向上/下滚动 iPod 菜单	▲/▼ 。可按照与 iPod 的点击式触摸转盘操作或 iPod touch 的上下拖动操作十分相似的方法向上或向下滚动 iPod 菜单。
选择有声读物/播客的曲目或章节	◀◀/▶▶ 。要快进或快倒时，按住该按钮。
选择所选项目	◆/⊕ （或主机上的 ENTER）。可按照与 iPod 上的中央按钮或 iPod touch 的触控操作十分相似的方法选择所选项目。
搜索有声读物/播客的曲目或章节中的一点	在播放期间按住 ◀◀/▶▶ ，然后在想要的点释放该按钮。
返回上一个菜单或选择菜单	◀/TOOL MENU/⌂ 。可按照与 iPod 上的菜单按钮或 iPod touch 的触控操作十分相似的方法返回上一个菜单或选择菜单。

要将本系统作为电池充电器使用时

当系统电源打开时，可将本系统作为 iPod 的电池充电器使用。

当 iPod 放在主机连接器上时，充电开始。充电状态显示在 iPod 的显示窗中。有关详细说明，请参见 iPod 的用户指南。

要停止给 iPod 充电时

取下 iPod。

注意

- 当放置或取下 iPod 时，按照与主机上的 iPod 连接器相同的角度操作 iPod，请勿扭曲或摇摆 iPod 以防止连接器受损。
- 请勿在 iPod 安装在连接器上的状态下携带主机。这样做可能会导致故障。
- 当放置或取下 iPod 时，用一只手固定主机并小心不要误按下 iPod 的控制器。
- 拔下 iPod 之前，请暂停播放。
- 要改变音量电平时，使用 VOLUME +/-。即使在 iPod 上进行调节，音量电平也不改变。
- 主机上的 iPod 基座专为 iPod 设计。不可以连接任何其他便携式音频播放机。
- 要使用 iPod 时，请参阅 iPod 的用户指南。
- 在本系统上使用 iPod 时，如果记录在 iPod 上的数据丢失或受损，Sony 恕不承担任何责任。

在本系统上使用 USB 设备之前

通过将选购 USB 设备连接到主机上的  (USB) 端口，可以在本系统上进行使用。确保使用 CCC 认证的 USB 设备。

有关使用 CCC 认证的 USB 设备的注意事项

不完全保证本系统与 CCC (中国强制性产品认证) 认证的 USB 设备的兼容性。这是由于根据制造商的不同，USB 设备的规格可能有所不同。

有关使用 USB 设备的方法的详细信息，请参阅随 USB 设备附带的操作手册。

注意

- 需要 USB 电缆连接时，请用附带的 USB 电缆连接要连接的 USB 设备。有关使用方法的详细说明，请参阅随要连接的 USB 设备附带的操作手册。
- 根据所连接 USB 设备类型的不同，到出现“READING”为止，可能需要大约 10 秒钟。
- 在传输或删除操作期间，请勿拔下 USB 设备。这样做可能会损毁 USB 设备上的数据或损坏 USB 设备本身。
- 请勿经由 USB 集线器连接本系统和 USB 设备。
- 当插入 USB 设备时，系统读取 USB 设备上的所有文件。如果 USB 设备上有许多文件夹或文件，到完成 USB 设备读取为止可能需要较长时间。

- 对于某些连接的USB设备，执行某一操作后到本系统执行该操作为止，可能会有一些延迟。
- 不保证与所有编码/写入软件、录制设备以及录制媒体的兼容性。不兼容的USB设备可能会发出噪音或发生音频中断或可能根本无法播放。
- 在下列情况下，本系统无法从光盘传输音乐或播放USB设备上的音频文件。
 - 当文件夹中的音频文件数目超过150时。
 - 当USB设备中的文件夹数目超过200时。
 根据文件和文件夹构造的不同，这些数目可能有所不同。请勿在含有音频文件的USB设备上保存其它类型的文件或不必要的文件夹。

要将本系统作为电池充电器使用时

当系统电源打开时，可将本系统作为具有充电功能的USB设备的电池充电器。

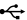
当USB设备连接到本系统的  (USB) 端口时充电开始。充电状态显示在USB显示窗中。有关详细说明，请参见USB设备的用户指南。

有关用本系统为USB设备充电的注意事项

在下列情况下，无法将本系统作为电池充电器使用。

- CD播放机/USB设备的电源关闭并且选择了调谐器功能。参见“要改善光盘的装载性能时”（第34页）。
- 当系统电源关闭时。

从光盘向USB设备传输音乐

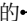
可将CCC认证的USB设备连接到主机上的  (USB) 端口并从光盘向USB设备传输音乐。

只可以从CD-DA光盘或MP3光盘传输音乐。

本系统传输的文件的音频格式为MP3。

当从CD传输音乐时，USB设备上需要有约为每分钟1 MB的剩余空间量。当从MP3光盘传输音乐时，需要的剩余空间可能更大。

可以轻松地将光盘上的所有音乐传输到USB设备 (CD SYNC)。还可以传输当前正在播放的曲目或MP3文件 (REC1)。

1 将USB设备连接到 (USB) 端口。

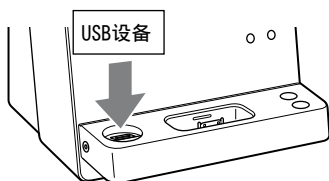

2 选择CD功能。

反复按FUNCTION +/-。

3 插入光盘。

4 将USB设备设定为传输待机状态。

同步传输 (CD SYNC) :

按主机上的REC TO USB。

要只传输您喜爱的CD曲目或MP3文件时，事先创建您自己的程序（参见“创建您自己的程序”（第23页））。

要只传输存储在MP3光盘上的指定文件夹中的MP3文件时，在开始传输之前，反复按 +/-选择想要的文件夹。

REC1:

开始播放想要传输的曲目或MP3文件，然后按主机上的REC TO USB。

“REC”闪烁，循环显示“CD SYNC (或“REC1”)”、“FREExxxM”或“FREExxxG”（以百万字节或十亿字节表示的USB设备上的剩余空间）以及“PUSH ENTER”。

USB设备处于传输待机状态，CD播放机处于播放暂停状态。

5 开始传输。

按⊕（或主机上的ENTER）。

传输开始。

当使用CD SYNC时

当传输结束时，对USB设备和CD播放机的访问自动停止。

当使用REC1时

当传输结束时，对USB设备的访问自动停止，CD播放机继续播放。

要选择USB设备上的存储器时

如果USB设备具有一个以上的存储器（例如：内部存储器和存储卡），可以选择要读入的存储器，然后开始传输。

1 将USB设备连接到 (USB) 端口。

2 选择USB功能。

反复按FUNCTION +/-。

3 在停止模式下按主机上的USB MENU。

出现“USB SEL”。如果选择了音频文件或文件夹，则会出现“ERASE”。反复按|◀◀/▶▶|选择“USB SEL”。

4 按⊕（或主机上的ENTER）。

出现存储器的名称。
根据USB设备规格的不同，显示的名称有所不同。

5 反复按|◀◀/▶▶|选择存储器。

如果只能选择一个存储器，进入步骤6。

要取消该操作时，按■。

6 按⊕（或主机上的ENTER）。

7 按照“从光盘向USB设备传输音乐”的步骤2至5开始传输。

要停止传输时

按■。

要从USB设备删除音频文件或文件夹时

可以从USB设备删除音频文件或文件夹。请注意，不能在任选播放模式或编程播放模式下删除音频文件和文件夹。

1 将USB设备连接到⏏（USB）端口。

2 选择USB功能。

反复按FUNCTION +/-。

3 反复按|◀◀/▶▶|或⏏ +/-选择想要删除的音频文件或文件夹。

4 按主机上的USB MENU。

出现“ERASE”。

5 按⊕（或主机上的ENTER）。

在显示窗中出现“TRACK ERASE”或“FOLDER ERASE”。

要取消删除操作时，按■。

6 按⊕（或主机上的ENTER）。

所选音频文件或文件夹被删除。

文件夹和文件生成规则

当首次传输音乐到USB设备时，直接在“ROOT”下面创建“MUSIC”文件夹。

在该“MUSIC”文件夹内生成的文件夹和文件如下。

CD SYNC¹⁾

音乐源	文件夹名称	文件名称
MP3	与音乐源相同 ²⁾	
CD-DA	“CDDA001” ³⁾	“TRACK001” ⁴⁾

REC1

音乐源	文件夹名称	文件名称
MP3	“REC1” ⁵⁾	与音乐源相同 ²⁾
CD-DA		“TRACK001” ⁴⁾

¹⁾ 在编程播放模式下，文件夹名称为“PGM_xxx”，文件名称取决于音乐源（CD-DA光盘或MP3光盘）。

²⁾ 最长指定64字符的名称。

³⁾ 之后顺次指定文件夹号码，最大为999（包括“ROOT”和“MUSIC”文件夹在内）。

⁴⁾ 之后顺次指定文件号码。

⁵⁾ 每次执行REC1时，会在“REC1”文件夹中创建一个新文件。

注意

- 当从CD传输音乐时，曲目被作为128 kbps的MP3文件传输。当从MP3光盘传输音乐时，将以与原始MP3文件相同的比特率传输MP3文件。
- 如果在任选播放模式、重复播放模式或编程播放模式（当没有曲目或MP3文件被编程时）下开始传输，所选播放模式被自动取消，播放模式切换到正常播放模式。
- 从MP3光盘传输音乐时，没有声音输出并且出现“HIGH-SPEED”。
- CD文本信息不被传输到所创建的MP3文件中。
- 如果中途取消传输，会创建一个到停止传输时刻为止的MP3文件。
- 下列情况下传输自动停止：
 - 在传输处理期间USB设备的剩余空间用尽。
 - USB设备上的音频文件数目达到系统能够识别的数目极限。
- 如果要删除的文件夹包含非MP3/WMA/AAC格式文件或子文件夹，这些不会被删除。
- 如果USB设备上已存在与您试图传输的文件夹或文件同名的文件夹或文件，会在名称后添加序号而不会盖写原始文件夹或文件。

播放USB设备的文件

可以收听连接的CCC认证的USB设备中存储的音乐。

本系统可以播放的音频格式如下：
MP3*/WMA*/AAC*

* 本系统不能播放带有版权保护（数码权限管理）的文件。
本系统可能无法播放从在线音乐商店下载的文件。

1 选择USB功能。

反复按FUNCTION +/-。

2 将USB设备连接到（USB）端口。

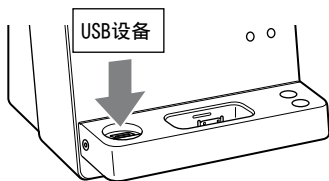

连接了USB设备时，显示改变如下：

“READING” → “STORAGE DRIVE*”

* 连接USB设备时，如果录制有卷标，接下来会显示该信息。

3 开始播放。

按（或主机上的）。

其它操作



要	按
暂停播放	（或主机上的）。要恢复播放时，再次按该按钮。
停止播放	。要恢复播放时，按（或主机上的）*。要取消恢复播放时，再次按。
选择一个文件夹	反复按 +/-。
选择一个文件	 / 。
找到文件中的 一点	在播放期间按住 / ，然后在想要的点释放该按钮。
选择反复播放	反复按REPEAT直到出现“REP”或“REP1”。

* 播放VBR（可变比特率）MP3/WMA文件时，本系统可能会从不同的位置恢复播放。

要改变播放模式时

在USB设备停止播放时，反复按PLAY MODE。可以选择正常播放（“”用于播放USB设备上的文件夹中的所有文件）、任选播放（“SHUF”或“ SHUF”）或编程播放（“PGM”）。

有关任选播放模式的注意事项

当关闭系统的电源时，所任选播放模式（“SHUF”或“ SHUF”）被清除，播放模式返回到正常播放模式（“”）。

注意

- 下列USB设备/情况下开始播放所需的时间会变长：
 - 以复杂树状结构录制的USB设备。
 - 存储容量非常大。
- 本系统只能播放到8层文件夹深度。
- 本系统未必支持所连接的USB设备所提供的全部功能。
- 关闭系统电源时，恢复播放被取消。
- 本系统的播放顺序可能与所连接USB设备的播放顺序不同。
- 没有音频文件的文件夹会被跳过。
- 本系统能够播放的文件格式如下：
 - MP3：文件扩展名“.mp3”
 - WMA文件：文件扩展名“.wma”
 - AAC：文件扩展名“.m4a”

请注意，即使文件名具有上述文件扩展名，如果实际文件不同，播放这些文件可能会产生损坏扬声器系统的强大噪音并且系统可能会发生故障。

创建您自己的程序 (编程播放)

用遥控器上的按钮创建您自己的程序。

1 选择想要的功能。

CD

反复按FUNCTION +/- 选择CD功能。

USB

反复按FUNCTION +/- 选择USB功能。

2 选择播放模式。

在系统停止播放时反复按PLAY MODE直到出现“PGM”。

3 选择想要的曲目或文件号码。

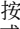
反复按  直到出现想要的曲目或文件号码。

在编制MP3文件时，反复按 +/- 选择想要的文件夹，然后选择想要的文件。

所选曲目或文件号码

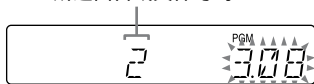

所选曲目或文件的
总播放时间

接下页 

4 编制所选的曲目或文件。

按⊕输入所选的曲目或文件。

CD

当CD的总编程时间超过100分钟，或当您选择MP3文件时，会显示“— —.— —”。

USB

不能显示总编程时间，故显示“— —.— —”。

5 重复步骤3至4编制其它曲目或文件，最多可编制总计25个曲目或文件。

6 要播放编程的曲目或文件时，按▶。

到取出光盘或拔下USB设备为止，程序将保持有效。要再次播放相同的程序时，按▶。

要取消编程播放时

在系统停止播放时反复按PLAY MODE直到“PGM”消失。

要删除编程的最后一个曲目或文件时

在系统停止播放时按CLEAR。

要观看如程序的总曲目数等程序信息时

反复按DISPLAY。

使用选购音频组件

- 1 准备音源。
用音频模拟导线（非附件）将附加的音频组件连接到主机上的AUDIO IN插孔。
- 2 调小音量。
按VOLUME -。
- 3 选择AUDIO IN功能。
反复按FUNCTION +/-。
- 4 开始播放。
开始播放连接的组件并调节音量。
- 5 调节音量。
按VOLUME +/-。



调节音质

要	按
生成更有活力的声音 (Dynamic Sound Generator X-tra)	主机上的DSGX。
设定声音效果	反复按EQ。

改变显示

要	按
改变显示窗中的信息 ¹⁾	在系统电源打开时反复按DISPLAY。
在系统电源关闭时查看时钟	在系统电源关闭时按DISPLAY ²⁾ 。时钟显示8秒钟。

¹⁾ 例如，可观看如下CD/MP3光盘信息或USB设备信息：

- 正常播放期间的曲目或文件号码。
- 正常播放期间的曲目或文件名（“”）。
- 正常播放期间的艺术家名（“”）。
- 正常播放期间的作品集或文件夹名（“”）。
- 播放机停止时的总播放时间。
- 卷标（如果光盘或USB设备上存在该信息）。

²⁾ 当系统电源关闭时，主机上的STANDBY指示灯点亮。

有关显示信息的注意事项

- 无法显示的字符作为“_”出现。
- 不显示下列内容：
 - MP3光盘和USB设备的总播放时间及剩余播放时间。
 - MP3文件的剩余播放时间。

- 下列内容不正确显示：
 - 采用VBR（可变比特率）编码的MP3文件的已经过播放时间。
 - 不符合ISO9660等级1、等级2或扩展格式Joliet标准的文件夹和文件名。
- 显示下列内容：
 - 正常播放期间的CD-DA光盘的总播放时间。
 - 曲目的剩余播放时间。
 - 正常播放期间的当前CD-DA光盘的剩余播放时间。
 - 使用ID3版本1和版本2标签时，显示MP3文件的ID3标签信息（当一个MP3文件同时使用了ID3版本1和版本2标签时，优先显示ID3版本2标签信息）。
 - 由大写字母(A到Z)、数字(0到9)和符号(" \$ % ' () * , - . / < = > @ [\] _ ` { | } ! ? ^) 构成的最多15个字符的ID3标签、WMA标签和AAC标签信息。

使用定时器

本系统提供两种定时器功能。如果同时使用播放定时器和入睡定时器，入睡定时器具有优先权。

用遥控器上的按钮使用定时器功能。

入睡定时器：

您可以听着音乐入睡。即使没有设定时钟，本功能仍然有效。

反复按SLEEP。

如果选择“AUTO”，本系统将在当前的光盘或USB设备停止后，或在100分钟后自动关闭电源。

播放定时器：

可以在预设的时间让CD、调谐器、iPod或选购USB设备唤醒您。

确保已经设定了时钟。

1 准备音源。

准备音源，然后按VOLUME +/- 调节音量。

要从指定的曲目或音频文件开始播放时，创建您自己的程序（第23页）。

2 选择定时器设定模式。

按TIMER MENU。

3 设定播放定时器。

反复按▲/▼选择“PLAY SET”，然后按⊕。

出现“ON TIME”，小时指示闪烁。

4 设定开始播放的时间。

反复按▲/▼设定小时，然后按⊕。分钟指示闪烁。使用上述步骤设定分钟。

显示窗中出现“OFF TIME”，小时指示闪烁。

5 用与步骤4相同的方法设定停止播放的时间。

6 选择音源。

反复按▲/▼直到出现想要的音源，然后按⊕。显示窗中显示定时器设置。

7 关闭系统电源。

按I/⏻。

系统电源在预设时间15秒前打开。如果系统在预设时间处于开启状态，播放定时器将不会被激活。从系统接通电源到播放开始为止的期间请勿操作系统。

要查看设置时

- 1 按TIMER MENU。
显示窗中的“SELECT”闪烁。
- 2 按⊕。
- 3 反复按▲/▼选择“PLAY SEL”。
- 4 按⊕。

要取消定时器时

- 1 按TIMER MENU。
显示窗中的“SELECT”闪烁。
- 2 按⊕。
- 3 反复按▲/▼选择“OFF”。
- 4 按⊕。

要改变设置时

从步骤1开始（第27页）。

iPod用户注意事项

- 当使用播放定时器时，请确保iPod未处于播放状态。
- 根据连接的iPod的状态，播放定时器可能不会被激活。

提示

只要没有手动取消设置，将一直保留播放定时器设置。

补充信息

故障排除

- 1 确保电源线和扬声器导线正确且牢固地连接。
- 2 从下面的故障排除清单中找出您的问题并执行所指示的纠正措施。如果仍然存在问题，请向就近的Sony代理商咨询。

如果STANDBY指示灯闪烁

立即拔下电源线并查看下列项目。

- 如果您的系统设有电压选择器，电压选择器是否设定为正确的电压？
- 是否只使用了附带的扬声器？
- 是否有物品堵塞系统顶部或背面的通风孔？
- iPod连接器是否短路？
在STANDBY指示灯停止闪烁后，重新连接电源线并打开系统电源。如果仍然存在问题，请向就近的Sony代理商咨询。

总体

无法打开系统电源。

- 是否插好了电源线？

没有声音。

- +和-扬声器导线是否短路？
- 是否只使用了附带的扬声器？
- 是否有物品堵塞系统顶部或背面的通风孔？
- 指定的电台可能暂时停止了广播。

拔下电源线后，STANDBY指示灯仍然点亮。

- 拔下电源线后，STANDBY指示灯可能不会立即关闭。这不是故障。指示灯将在大约40秒之后熄灭。

只有一个声道有声音，或左右音量不均衡。

- 将扬声器摆放得尽可能对称。
- 请只连接附带的扬声器。

严重的嗡嗡声或噪音。

- 将本系统从噪音源附近移开。
- 将本系统连接到不同的墙上电源插座。
- 在电源线上安装噪音滤波器（另售）。

遥控器不工作。

- 清除遥控器和主机上的遥控传感器之间的障碍物，并将主机放在远离荧光灯的位置。
- 把遥控器指向本系统的传感器。
- 使遥控器靠近本系统。

CD/MP3播放机

声音间断，或无法播放光盘。

- 擦净光盘，并重新放入光盘。
- 将本系统移动到没有振动的地方（例如：稳固的架子上）。
- 将扬声器从本系统旁移开，或将它们摆放在分开的架子上。音量较大时，扬声器的振动可能会导致声音间断。

播放不从第一个曲目开始。

- 通过反复按PLAY MODE直到“PGM”和“SHUF”均消失以返回正常播放。

等待开始播放的时间比平时长。

- 下列光盘开始播放所需的时间会变长。
 - 以复杂树状结构录制的光盘
 - 以多区段模式录制的光盘
 - 未终结化的光盘（可以添加数据的光盘）
 - 包含许多文件夹的光盘

系统不退出光盘并显示“LOCKED”。

- 请与Sony代理商或当地授权的Sony服务处联系。

iPod

没有声音。

- 确保牢固地连接iPod。
- 确保iPod正在播放音乐。
- 调节音量。

声音失真。

- 调小音量。
- 将iPod的“均衡器”设置设定为“关闭”或“Flat”。

遥控器不工作。

- 确保已用最新软件更新了iPod。如果尚未更新，请在本系统上使用之前更新iPod。

无法为iPod充电。

- 确保牢固地连接iPod。
- 只在系统电源打开时，可将本系统作为iPod的电池充电器使用。

出现“OVER CURRENT”。

- 从iPod连接器检测到电流电平问题。关闭系统电源并从iPod连接器上取下iPod。确保iPod没有问题。如果该显示信息持续存在，请与就近的Sony代理商联系。

USB设备

无法为连接的USB设备充电。

- 选择调谐器功能以外的功能或打开CD播放机/USB设备的电源。参见“要改善光盘的装载性能时”（第34页）。

同时连接了 iPod和USB设备时，为连接的iPod充电，但不为USB设备充电。

- 选择调谐器功能以外的功能或打开CD播放机/USB设备的电源。参见“要改善光盘的装载性能时”（第34页）。

无法开始向USB设备进行传输。

- 可能发生了下列问题。
 - USB设备已满。
 - USB设备上的文件和文件夹数目已达到上限。
 - USB设备设有写保护。

传输完成前停止。

- 正在使用不受支持的USB设备。
- 没有正确地格式化USB设备。有关格式化方法，请参阅USB设备的操作手册。
- 关闭系统电源并拔下USB设备。如果USB设备设有电源开关，将USB设备从系统上拔下后，关闭USB设备并重新打开。然后重新执行传输。

- 如果重复传输和删除操作多次，USB设备内的文件结构会发生断离。有关如何解决该问题，请参阅USB设备的操作手册。如果该问题持续存在，请与就近的Sony代理商联系。

传输音乐到USB设备发生错误。

- 正在使用不受支持的USB设备。
- 关闭系统电源并拔下USB设备。如果USB设备设有电源开关，将USB设备从系统上拔下后，关闭USB设备并重新打开。然后重新执行传输。
- 传输过程中USB设备断开连接或电源关闭。删除部分传输的文件，然后重新进行传输。如果这样做无法解决问题，USB设备可能有故障。有关如何解决该问题，请参阅USB设备的操作手册。如果该问题持续存在，请与就近的Sony代理商联系。

无法删除USB设备上的文件或文件夹。

- 查看USB设备是否设有写保护。
- 删除操作期间USB设备断开连接或电源关闭。删除部分删除的文件。如果这样做无法解决问题，USB设备可能有故障。有关如何解决该问题，请参阅USB设备的操作手册。如果该问题持续存在，请与就近的Sony代理商联系。

正在使用受支持的USB设备吗？

- 如果连接了不受支持的USB设备，可能发生下列问题。
 - USB设备不被识别。
 - 本系统上不显示文件或文件夹名称。
 - 无法播放。
 - 声音间断。
 - 有噪音。
 - 输出失真的声音。
 - 传输完成前停止。

出现“OVER CURRENT”。

- 从USB (USB) 端口检测到电流电平问题。关闭系统电源并从USB (USB) 端口上拔下USB设备。确保USB设备没有问题。如果该显示信息持续存在，请与就近的Sony代理商联系。

没有声音。

- 没有正确连接USB设备。关闭系统电源，然后重新连接USB设备。

有噪音、声音间断或失真。

- 关闭系统电源，然后重新连接USB设备。
- 音乐数据本身包含噪音或声音失真。可能在传输过程中混入了噪音。删除文件，然后重新尝试传输。

USB设备无法连接到USB (USB) 端口。

- 反向连接了USB设备。以正确方向连接USB设备。

长时间显示“READING”，或到播放开始为止花费的时间较长。

- 在下列情况下，读取过程会花费较长时间。
 - USB设备上有许多文件夹或文件。
 - 文件结构极为复杂。
 - 存储容量非常大。
 - 内部存储器发生了断离现象。因此，建议您按照下列方针进行操作。
 - USB设备上的文件夹总数：100或更少
 - 每个文件夹的文件总数：100或更少

错误显示

- 由于存储在USB设备中的数据可能已经损毁，请再次向USB设备发送音乐数据。
- 本系统可以显示的字符代码只有数字和字母。其它字符不正确显示。

USB设备不被识别。

- 关闭系统电源并重新连接USB设备，然后打开系统电源。
- USB设备不正确工作。有关如何解决该问题，请参阅USB设备的操作手册。如果该问题持续存在，请与就近的Sony代理商联系。

播放不开始。

- 关闭系统电源并重新连接USB设备，然后打开系统电源。
- 按▶（或主机上的▶||）以开始播放。

播放不从第一个曲目开始。

- 将播放模式设定为正常播放模式。

无法播放文件。

- 音频文件不具有扩展名“.mp3”、“.wma”或“.m4a”。
- 未以MP3/WMA/AAC格式存储数据。
- 以FAT16或FAT32以外的文件系统格式化的USB存储设备不受支持。*
- 如果使用分区的USB存储设备，只能播放第一个分区中的文件。
- 最多可播放8个层次。
- 文件夹数目已超过999。
- 文件数目已超过999。
- 不能播放加密或受到密码保护等的文件。

* 本系统支持FAT16和FAT32，但是某些USB存储设备可能不支持所有这些FAT格式。有关详细说明，请参阅各USB存储设备的操作手册或与制造商联系。

调谐器

有严重的嗡嗡声或噪音，或无法接收电台。（显示窗中“TUNED”或“ST”闪烁。）

- 正确连接天线。
- 寻找接收效果良好的场所和方向，然后重新设置天线。
- 令天线远离扬声器导线、电源线和USB电缆，以避免受到噪音干扰。
- 关闭附近的电器设备。

能够同时收听多个电台。

- 寻找接收效果良好的场所和方向，然后重新设置天线。
- 例如用市售的电线夹捆上天线电缆，并调节电缆长度。

要改变AM调谐间隔时

出厂时AM调谐间隔预设设为9 kHz（某些地区为10 kHz）。

使用主机上的按钮改变AM调谐间隔。

1 调入任何AM电台，然后关闭系统电源。

2 按DISPLAY显示时钟。

3 在按住▶▶期间按I/⏻。

所有AM预设电台都会被删除。要间隔重设为出厂预设时，重复上述步骤。

要改善光盘的装载性能时

使用CD/USB电源管理功能打开CD播放器/USB设备的电源。默认设置下，CD播放器/USB设备的电源关闭。

使用主机上的按钮打开CD播放器/USB设备电源。

1 反复按FUNCTION +/-选择CD功能。

2 按I/⏻关闭系统电源。

3 在“STANDBY”停止闪烁后，按DISPLAY显示时钟，然后在按住■期间按I/⏻。

出现“CD/USB PWR ON”。打开CD播放器/USB设备电源可以减少光盘访问时间并改善装载性能。

如果在打开CD播放器/USB设备电源时调谐器接收效果差，将该设置恢复默认设置。

要关闭CD播放器/USB设备电源时，重复该操作直至出现“CD/USB PWR OFF”。

请注意，当在关闭CD播放器/USB设备电源情况下选择调谐器功能时，不向USB设备供应电源，因此即使连接设备，系统也不会识别该设备，并且不会为其充电。

要将系统重设为出厂设置时

如果系统仍然无法正常工作，请将系统重设为出厂设置。

使用主机上的按钮将系统复位为出厂默认设置。

1 拔下并重新连接电源线，然后接通系统的电源。

2 按住■和ENTER，然后按I/⏻。

所有用户配置的设置（如预设电台、定时器和时钟等）均会被删除。

讯息

在操作期间，可能会在前面板显示窗中出现或闪烁下列讯息之一。

CANNOT PLAY

您试图播放USB设备上不受支持的文件。

COMPLETE

- 电台预设操作正常结束。
- USB设备上的音频文件或文件夹已被删除。

DATA ERROR

您试图播放USB设备上无法播放的文件。

DEVICE ERROR

无法识别USB设备或连接了未知设备（第32、33页）。

DEVICE FULL

USB设备已满。

ERASE ERROR

删除USB设备上的音频文件或文件夹操作失败。

ERROR

- 无法识别USB设备或连接了未知设备（第32、33页）。
- 开始播放时所连接的USB设备发生未知问题。

FATAL ERROR

在传输或删除USB设备上的音频文件或文件夹时USB设备断开连接。

FOLDER FULL

USB设备上的文件夹数目已达到最大数。

FULL

您试图编制25个以上的曲目或文件（步骤）。

LOCKED

系统不退出光盘。请向就近的Sony代理商咨询。

NoDEVICE

没有连接USB设备或所连接的USB设备已停止。

NO DISC

播放机中没有光盘，或您装载了无法播放的光盘。

NO STEP

所有已编程曲目或文件都被清除。

NO TRACK

USB设备上的可播放文件未被装载到本系统中。

NOT USED

您试图在禁止某一操作的条件下执行该操作。

NO SUPPORT

连接了不受支持的USB设备。

OVER

在播放或暂停期间按▶▶时已到达光盘的末尾。

PROTECTED

您试图对设有写保护的USB设备进行传输或删除操作。

PUSH STOP

- 在播放期间按下了PLAY MODE。
- 按下了只在播放停止时能够进行操作的按钮。

READING

- 本系统正在读取光盘信息。某些按钮无效。
- 本系统正在识别USB设备。

REC ERROR

传输没有开始，途中停止，或因其它因素无法执行（第31页）。

REMOVED

已拔下USB设备。

STORAGE DRIVE

连接了USB设备。

TIME NG

播放定时器的开始和结束时间设定了同一时间。

TRACK FULL

USB设备上的文件数目已达到最大数。

显示示例

显示	表示
2	2 (二)
5	5 (五)
6	6 (六)
8	8 (八)
0	0 (零)
A	A
B	B
D	D
G	G
H	H
K	K
M	M
O	O
Q	Q
R	R
S	S
Z	Z
!	! 或
"	"
\$	\$
%	%
,	,
.	.
?	?
@	@
-	-

使用须知

本系统能够播放的光盘

- 音频CD
- CD-R/CD-RW (音频数据/MP3文件)

本系统不能播放的光盘

- CD-ROM
- 以音乐CD格式或符合ISO9660等级1/等级2、Joliet的MP3格式以外的格式录制的CD-R/CD-RW
- 以多区段录制而未以“关闭区段”结束的CD-R/CD-RW
- 录音质量差的CD-R/CD-RW, 有划痕或肮脏的CD-R/CD-RW, 或使用不兼容的录制设备录制的CD-R/CD-RW
- 未正常终结化的CD-R/CD-RW
- 含有MPEG 1 Audio Layer-3 (MP3) 文件以外文件的光盘
- 非标准形状的光盘 (例如: 心形、方形、星形)
- 贴有粘性透明胶带、纸或不干胶的光盘
- 贴有封条的租借光盘或旧光盘而粘胶扩展到了封条外侧
- 使用摸上去感到黏的墨水印刷标签的光盘

接下一页 

有关光盘的注意事项

- 播放前，请用清洁布从中央向外擦拭光盘。
- 请勿使用诸如汽油、稀释剂、市售洗涤剂或用于乙烯基LP的防静电喷雾剂等溶剂清扫光盘。
- 请勿将光盘暴露在直射阳光下或诸如热通风管道一类的热源附近，也不要放在停放在直射阳光下的汽车里。

安全须知

- 若长时间不使用本系统，应从墙上电源插座完全拔下本系统的电源线。拔下本机电源线时，务必握持其插头。切勿拉扯电线本身。
- 万一有物体或液体落入系统内部，应拔下本系统的电源线，经专业人员检查后方可再次使用。
- 交流电源线必须仅在特约服务站更换。

安放须知

- 请勿将本系统安放在倾斜位置或极热、极冷、多尘、肮脏、潮湿或通风不良、或有振动、直射阳光或明亮光线之处。
- 当把本机或扬声器放在经过特殊处理（例如：打蜡、涂油、抛光等）的表面上时，可能会导致表面着色或褪色，请留意。

- 如果将本系统从寒冷处直接搬入温暖处或安放在极为潮湿的房间里，湿气可能会凝结在CD播放机内部的透镜上，并导致系统故障。这种情况下，请取出光盘，打开系统电源放置大约一个小时，直到湿气蒸发掉。

关于蓄热

- 工作期间本机蓄热是正常现象，这不是故障。
- 如果在高音量大下连续使用本系统，机壳的温度会升高，因此请您不要触摸机壳。
- 请勿堵塞通风孔。

关于扬声器系统

本扬声器系统未经过磁屏蔽处理，因此附近的电视机上的图像可能会发生磁性失真。这种情况下，请关闭电视机电源，等待15至30分钟后再打开。如果没有改善，请将扬声器放在远离电视机的位置。

清洁机壳

请用沾有少许中性清洁剂的软布清洁本系统。请勿使用任何类型的研磨片、擦洗粉或诸如稀释剂、汽油或酒精之类的溶剂。

规格

主机

放大器部

DIN功率输出 (额定) :
 2 + 2 W (1 kHz时为4 ohms,
 DIN)
 连续RMS功率输出 (参考值) :
 3 + 3 W (1 kHz时为4 ohms, 10%
 THD)

输入

AUDIO IN (立体声迷你插孔) :
 阻抗22 kilohms

输出

PHONES (立体声迷你插孔) :
 可插接阻抗为8 ohms或以上的耳机
 SPEAKER: 可插接4 ohms的阻抗

USB部

支持的比特率:
 MP3 (MPEG 1 Audio Layer-3) :
 32 - 320 kbps, VBR
 WMA: 32 - 192 kbps, VBR
 AAC: 48 - 320 kbps
 采样频率:
 MP3 (MPEG 1 Audio Layer-3) :
 32/44.1/48 kHz
 WMA: 44.1 kHz
 AAC: 44.1 kHz
 (USB) 端口:
 最大电流:
 500 mA

CD播放机部

系统:
 CD光盘和数字音频系统
 激光二极管特性
 放射持续时间: 连续
 激光输出*: 低于44.6 μ W
 * 本输出为距离光学拾音单元上的物
 镜表面200 mm处以7 mm开口测得的
 数值。

调谐器部

FM立体声, FM/AM超外差式调谐器

FM调谐器部:

调谐范围:
 87.5 - 108.0 MHz (50 kHz间
 隔)
 天线: FM导线天线
 中频: 10.7 MHz

AM调谐器部:

调谐范围:
 531 - 1602 kHz (9 kHz间隔)
 530 - 1610 kHz (10 kHz间隔)
 天线: AM环形天线
 中频: 450 kHz

扬声器

扬声器系统:
 全范围, 低音反射性, 80 mm,
 锥形
 额定阻抗: 4 ohms
 尺寸 (宽/高/深) :
 约130 × 221 × 135 mm
 质量: 每个扬声器净重约0.7 kg

总体

电源要求:

220 V AC, 50/60 Hz

功耗: 28 W

尺寸 (宽/高/深) (扬声器除外):

约200 × 221 × 205 mm

质量 (扬声器除外): 约2.2 kg

附件: 遥控器 (1), R6 (AA尺寸) 电池

(2), FM导线/AM环形天线 (1)

设计和规格如有变更, 恕不另行通知。

某些电路板没有使用卤化阻燃剂。

请拨打如下电话号码以获得本系统的
用户支持服务。

索尼中国顾客免费咨询热线

TEL: 400-810-9000

<http://www.sony.com.cn/>

与本系统兼容的 iPod 机型

可以在本系统上使用下列 iPod 机型。使用前请用最新软件更新 iPod。



iPod touch
第二代



iPod nano
第四代
(视频)



iPod touch
第一代



iPod nano
第三代
(视频)



iPod classic



iPod nano
第二代
(铝质)



iPod 第五代
(视频)



iPod nano
第一代



iPod 第四代
(彩屏)



iPod 第四代



iPod mini

