

Micro Hi-Fi Component System

Operating Instructions
CMT-EH15



© 2010 Sony Corporation

Printed in China

<http://www.sony.net/>

WARNING

To reduce the risk of fire or electric shock, do not expose this apparatus to rain or moisture.

To reduce the risk of fire or electric shock, do not place objects filled with liquids, such as vases, on the apparatus.

To reduce the risk of fire, do not cover the ventilation opening of the apparatus with newspapers, tablecloths, curtains, etc.

Do not place the naked flame sources such as lighted candles on the apparatus.

As the main plug is used to disconnect the unit from the mains, connect the unit to an easily accessible AC outlet. Should you notice an abnormality in the unit, disconnect the main plug from the AC outlet immediately.

Do not install the appliance in a confined space, such as a bookcase or built-in cabinet.

Do not expose batteries or apparatus with battery-installed to excessive heat such as sunshine, fire or the like.

Notice for customers: the following information is only applicable to equipment sold in countries applying EU directives.

The manufacturer of this product is Sony Corporation, 1-7-1 Konan Minato-ku, Tokyo, 108-0075 Japan. The Authorized Representative for EMC and product safety is Sony Deutschland GmbH, Hedelfinger Strasse 61, 70327 Stuttgart, Germany. For any service or guarantee matters, please refer to the addresses given in separate service or guarantee documents.



Disposal of Old Electrical & Electronic Equipment
(Applicable in the European Union and other European countries with separate collection systems)

This symbol on the product or on its packaging indicates that this product shall not be treated as household waste. Instead it shall be handed over to the applicable collection point for the recycling of electrical and electronic equipment. By ensuring this product is disposed of correctly, you will help prevent potential negative consequences for the environment and human health, which could otherwise be caused by inappropriate waste handling of this product. The recycling of materials will help to conserve natural resources. For more detailed information about recycling of this product, please contact your local Civic Office, your household waste disposal service or the shop where you purchased the product.

Applicable accessories: Remote commander



Disposal of waste batteries
(applicable in the European Union and other European countries with separate collection systems)

This symbol on the battery or on the packaging indicates that the battery provided with this product shall not be treated as household waste. On certain batteries this symbol might be used in combination with a chemical symbol. The chemical symbols for mercury (Hg) or lead (Pb) are added if the battery contains more than 0.0005% mercury or 0.004% lead. By ensuring these batteries are disposed of correctly, you will help prevent potentially negative consequences for the environment and human health which could otherwise be caused by inappropriate waste handling of the battery. The recycling of the materials will help to conserve natural resources. In case of products that for safety, performance or data integrity reasons require a permanent connection with an incorporated battery, this battery should be replaced by qualified service staff only. To ensure that the battery will

be treated properly, hand over the product at end-of-life to the applicable collection point for the recycling of electrical and electronic equipment.

For all other batteries, please view the section on how to remove the battery from the product safely. Hand the battery over to the applicable collection point for the recycling of waste batteries.

For more detailed information about recycling of this product or battery, please contact your local Civic Office, your household waste disposal service or the shop where you purchased the product.

Note on DualDiscs

A DualDisc is a two sided disc product which mates DVD recorded material on one side with digital audio material on the other side. However, since the audio material side does not conform to the Compact Disc (CD) standard, playback on this product is not guaranteed.

Music discs encoded with copyright protection technologies

This product is designed to playback discs that conform to the Compact Disc (CD) standard. Recently, various music discs encoded with copyright protection technologies are marketed by some record companies. Please be aware that among those discs, there are some that do not conform to the CD standard and may not be playable by this product.

MPEG Layer-3 audio coding technology and patents licensed from Fraunhofer IIS and Thomson.

Basic Operations

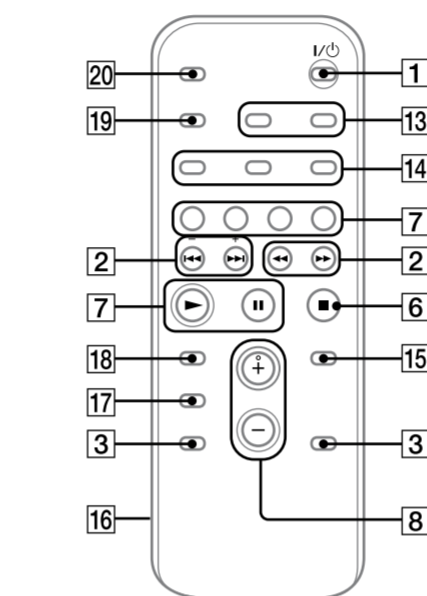
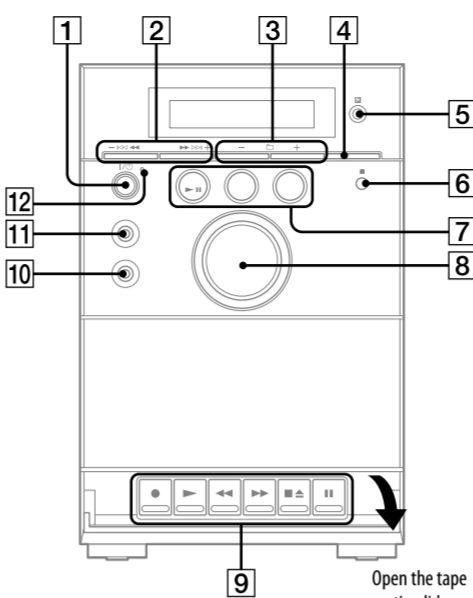

This manual mainly explains operations using the remote, but the same operations can also be performed using the buttons on the unit having the same or similar names.

Before using the system

To use the remote

Slide and remove the battery compartment lid [16], and insert the two R6 (size AA) batteries (not supplied), **+** side first, matching the polarities shown below.

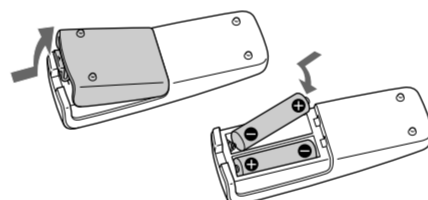

Notes on using the remote

- With normal use, the batteries should last for about six months.
- Do not mix an old battery with a new one or mix different types of batteries.
- If you do not use the remote for a long period of time, remove the batteries to avoid damage from battery leakage and corrosion.

To set the clock

Use buttons on the remote to set the clock.

- 1 Turn on the system.
Press I/O (on/standby) [1].
- 2 Select the clock set mode.
Press CLOCK/TIMER SET [13]. If the current mode appears, press I/II [2] repeatedly to select "CLOCK," and then press ENTER [15].
- 3 Set the time.
Press I/II [2] repeatedly to set the hour, and then press ENTER [15]. Use the same procedure to set the minutes.
The clock settings are lost when you disconnect the power cord or if a power failure occurs.

Selecting a music source

Press the following buttons (or press FUNCTION [7] repeatedly).

To select	Press
CD	CD [7].
Tuner	TUNER/BAND [7].
Tape	FUNCTION [7] repeatedly until "TAPE" appears.
Component* (connected using an audio cord)	AUDIO IN [7].

* If the component has the AVLS (Automatic Volume Limiter System) or BASS BOOST function, turn off the function to avoid distorted sound from the speakers.

Adjusting the sound

To adjust the volume

Press VOLUME +/- (or turn the VOLUME control on the unit) [8].

To add a sound effect

To	Press
Generate a more dynamic sound (Dynamic Sound Generator X-tra)	DSGX [4] on the unit.
Set the sound effect	EQ [17].

Playing a CD/MP3 disc

- 1 Select the CD function.
Press CD (or FUNCTION repeatedly) [7].
- 2 Place a disc.
Press **▲**PUSH OPEN/CLOSE on the unit, and place a disc with the label side up on the CD compartment. To close the CD compartment, press **▲**PUSH OPEN/CLOSE on the unit.

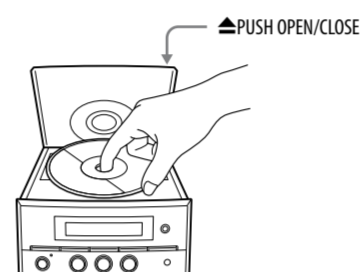

- 3 Start playback.
Press **▶** (play) (or CD/▶|| (play/pause) on the unit) [7].

To	Press
Pause playback	(pause) (or CD/▶ on the unit) [7]. To resume play, press it again.
Stop playback	■ (stop) [6].
Select a folder on an MP3 disc	⏪ +/- (select folder) [3].
Select a track or file	⏮ ⏭ (go back/go forward) (⏮ ⏭/⏭ ⏮) on the unit) [2].
Find a point in a track or file	Hold down ⏮ ⏭ (rewind/fast forward) [2] during playback, and release it at the desired point.
Select Repeat Play	REPEAT [14] repeatedly until "REP" or "REP1" appears.

To change the play mode

Press PLAY MODE [14] repeatedly while the player is stopped. You can select normal play ("□") for all MP3 files in the folder on the disc, shuffle play ("SHUF" or "□ SHUF*"), or program play ("PGM").

* When playing a CD-DA disc, □ (SHUF) Play performs the same operation as SHUF Play.

Notes on Repeat Play

- All tracks or files on a disc are played repeatedly up to five times.
- "REP1" indicates that a single track or file is repeated until you stop it.

Notes on playing MP3 discs

- Do not save other types of tracks or files or unnecessary folders on a disc that has MP3 files.
- Folders that have no MP3 files are skipped.
- MP3 files are played back in the order that they are recorded onto the disc.
- The system can only play MP3 files that have a file extension of ".MP3".
- If there are files on the disc that have the ".MP3" file extension, but that are not MP3 files, the unit may produce noise or may malfunction.
- The maximum number of:
 - folders is 150 (including the root folder).
 - MP3 files is 255.
 - MP3 files and folders that can be contained on a single disc is 256.
 - folder levels (the tree structure of files) is 8.
- Compatibility with all MP3 encoding/writing software, recording device, and recording media cannot be guaranteed. Incompatible MP3 discs may produce noise or interrupted audio or may not play at all.

Notes on playing multisession discs

- If the disc begins with a CD-DA (or MP3) session, it is recognized as a CD-DA (or MP3) disc, and playback continues until another session is encountered.
- A disc with a mixed CD format is recognized as a CD-DA (audio) disc.

Listening to the radio

- 1 Select "FM" or "AM."
Press TUNER/BAND [7] repeatedly.
- 2 Select the tuning mode.
Press TUNING MODE [14] repeatedly until "AUTO" appears.
- 3 Tune in the desired station.
Press +/- (or TUNING +/- on the unit) [2]. Scanning stops automatically when a station is tuned in. When you tune in a station that provides RDS services, the station name appears.

Tip

To stop automatic scanning, press ■ (stop) [6].

To tune in a station with a weak signal

Press TUNING MODE [14] repeatedly until "MANUAL" appears, and then press +/- (or TUNING +/- on the unit) [2] repeatedly to tune in the desired station.

To reduce static noise on a weak FM stereo station

Press FM MODE [14] repeatedly until "MONO" appears to turn off stereo reception.

Playing a tape

Use buttons on the unit to play a tape.

- 1 Select the tape function.
Press FUNCTION [7] repeatedly.
- 2 Insert a tape.
Press **■▲** (stop/eject) [9], and insert the tape into the cassette holder. Make sure there is no slack in the tape to avoid damaging the tape or the tape deck.
- 3 Start playback.
Press **▶** (play) [9].

To	Press
Pause playback	(pause) [9]. To resume play, press it again.
Stop playback	■▲ (stop/eject) [9].
Rewind or fast forward*	◀▶ (rewind/fast forward) [9].

* Be sure to press **■▲** (stop/eject) [9] after the tape has been wound or rewound to the end.

Note

Do not turn off the system during playback or recording.

Changing the display

To change	Press
Information on the display ¹⁾	DISPLAY [19] repeatedly when the system is on.
Display mode (Clock)	DISPLAY [19] when the system is off ²⁾ . The clock is displayed for eight seconds.

¹⁾ For example, you can view CD/MP3 disc information, such as the track or file number or folder name during normal play, or the total play time while the player is stopped.

²⁾ The STANDBY indicator [12] lights up when the system is turned off.

Notes on the display information

- The following are not displayed:
 - total playing time for a CD-DA disc depending on the play mode.
 - total playing time for an MP3 disc.
 - remaining playing time for a track and an MP3 file.
- The following are not displayed correctly:
 - elapsed playing time of an MP3 file encoded using VBR (variable bit rate).
 - folder and file names that do not follow either ISO9660 Level 1, Level 2 or Joliet in the expansion format.
- The following are displayed:
 - ID3 tag information for MP3 files when ID3 version 1 and version 2 tags are used.
 - up to 15 characters of ID3 tag information using uppercase letters (A to Z), numbers (0 to 9), and symbols (< > * + - / @ [\] _).

Using optional audio components

To connect an optional headphones

Connect headphones to the PHONES jack [10] on the unit.

To connect an optional component

Connect additional audio source component to the AUDIO IN jack [11] on the unit using an audio analog cord (not supplied). Turn down the volume on the system, and then select the AUDIO IN function.

Hooking up the system securely

Power

For models with a voltage selector, set VOLTAGE SELECTOR to the local power line voltage.

Connect the power cord to a wall socket. If the plug does not fit the wall socket, detach the supplied plug adaptor (only for models equipped with an adaptor).

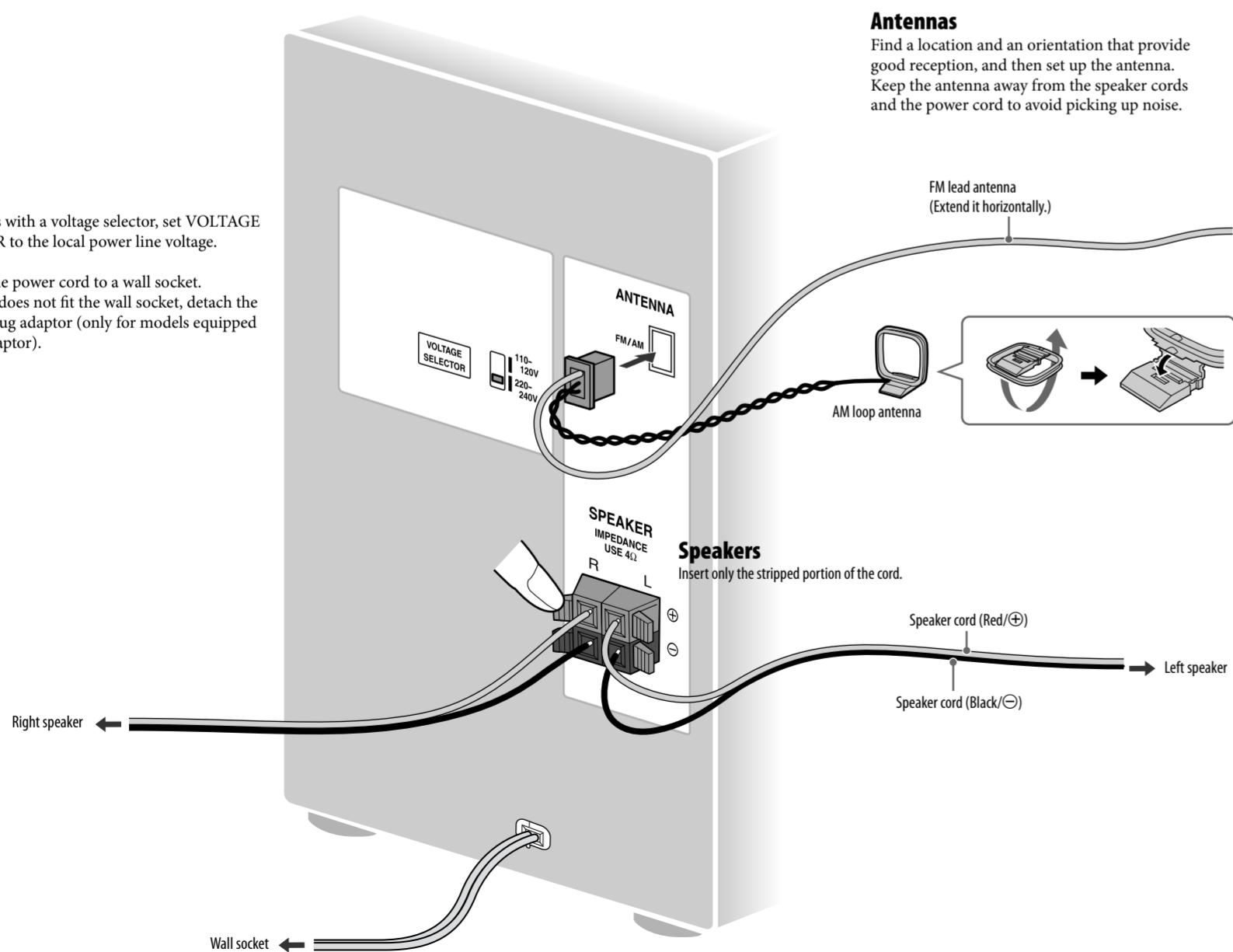

Antennas

Find a location and an orientation that provide good reception, and then set up the antenna. Keep the antenna away from the speaker cords and the power cord to avoid picking up noise.

FM lead antenna
(Extend it horizontally.)

AM loop antenna

Speakers

Insert only the stripped portion of the cord.

Speaker cord (Red/⊕)

Speaker cord (Black/⊖)

Left speaker

Right speaker

Wall socket

