

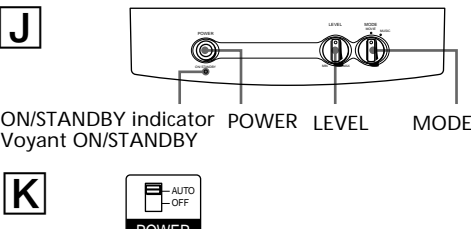

4-233-674-22(1)

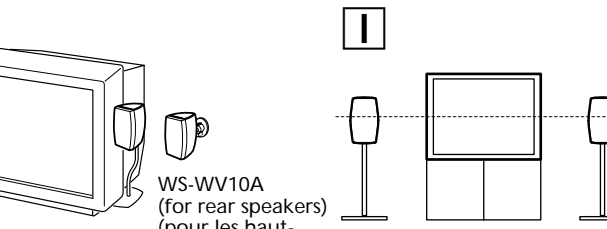
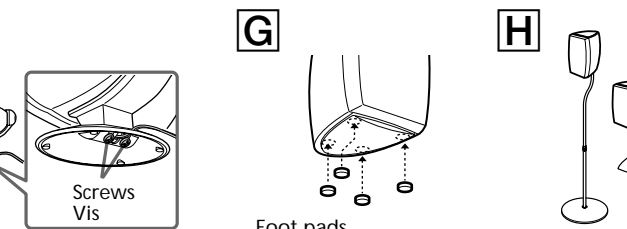
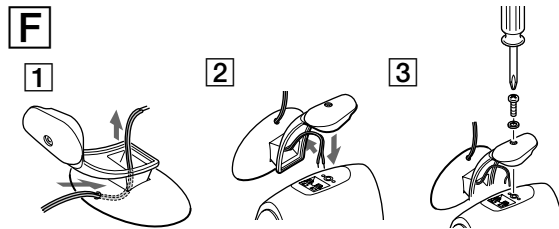
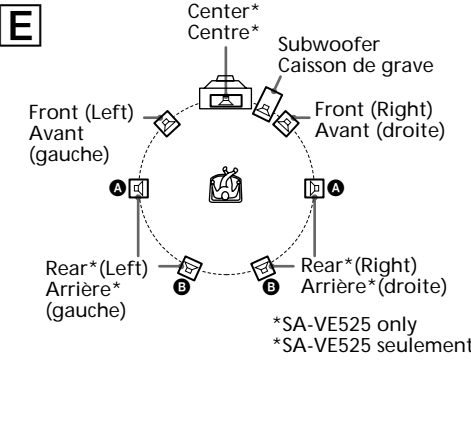
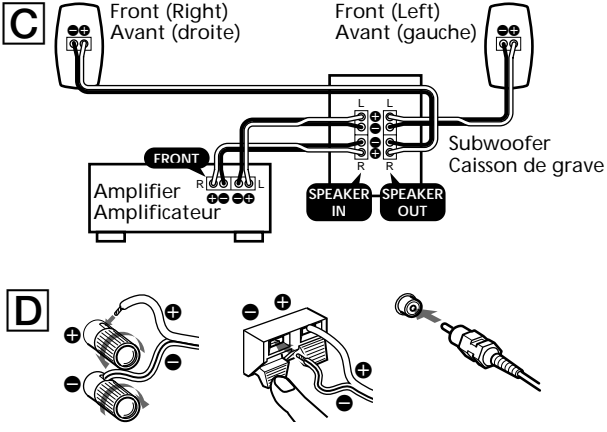
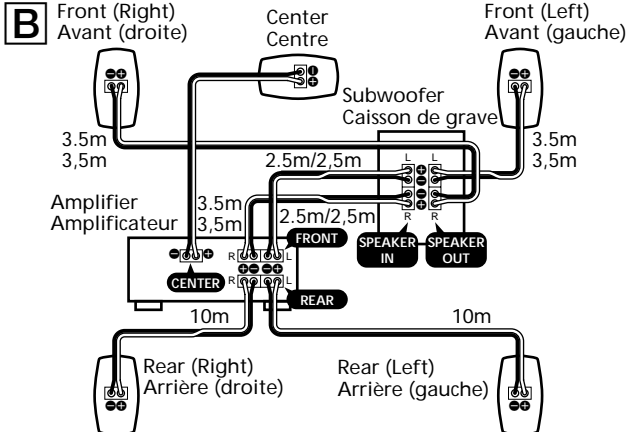
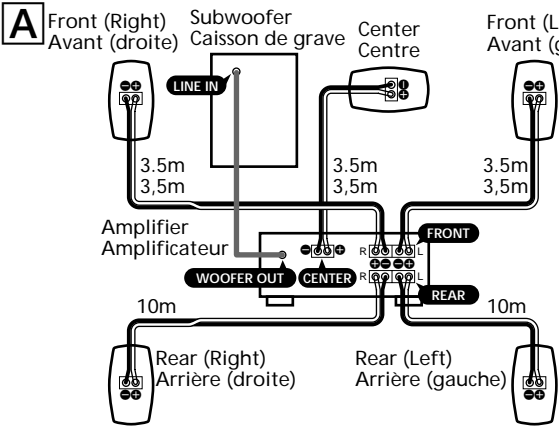

## English

### WARNING

To prevent fire or shock hazard, do not expose the unit to rain or moisture.  
To prevent fire, do not Cover the ventilation of the apparatus with news papers, table-cloths, curtains, etc. And don't place lighted candles on the apparatus.  
To prevent fire or shock hazard, do not place vases on the apparatus.  
To avoid electrical shock, do not open the cabinet. Refer servicing to qualified personnel only.

Do not install the appliance in a confined space, such as a bookcase or built-in cabinet.

### CAUTION

You are cautioned that any changes or modification not expressly approved in this manual could void your authority to operate this equipment.

## About this manual

The instructions in this manual are for SA-VE525 and SA-VE522. Sony Micro Satellite Systems.

### Differences between the systems

- SA-VE525
  - The SA-VE525 is a 5.1 channel speaker system consisting of two front speakers, two rear speakers, one center speaker, and one subwoofer. It supports Sony Digital Cinema Sound, Dolby® Pro Logic, and Dolby Digital (AC-3), and is thus gearedtowards the enjoyment of movies.
- SA-VE522
  - Consisting of two front speakers and one subwoofer, the SA-VE522 is suited for the enjoyment of music.

\* Manufactured under license from Dolby Laboratories. DOLBY, the double-D symbol , PRO LOGIC and™ and™ Dolby Digital (AC-3) are trademarks of Dolby Laboratories.

Any difference in operation is clearly indicated in the text, for example, "SA-VE525 only".

## Precautions

### On safety

- Before operating the system, be sure that the operating voltage of the system is identical with that of your local power supply.
- The unit is not disconnected from the AC power source (mains) as long as it is connected to the wall outlet, even if the unit itself has been turned off.
- Unplug the system from the wall outlet if it is not to be used for an extended period of time. To disconnect the cord, pull the cord by grasping the plug. Never pull the cord itself.
- Should any liquid or solid object fall into the system, unplug the system's power cord and have the system checked by qualified personnel before operating it any further.
- AC power cord must be changed only at the qualified service shop.

### On operation

- Do not drive the speaker system with a continuous wattage exceeding the maximum input power of the system.
- If the polarity of the speaker connections are not correct, the bass tones will be weak and the position of the various instruments obscure.
- Contact between bare speaker wires at the speaker terminals may result in a short-circuit.
- Before connecting, turn off the amplifier to avoid damaging the speaker system.

### If you encounter color irregularity on a nearby TV screen

This speaker system is magnetically shielded to allow it to be installed near a TV set. However, color irregularities may still be observed on certain types of TV sets.

### If color irregularity is observed...

→Turn off the TV set once, then turn it on again after 15 to 30 minutes.

### If color irregularity is observed again...

→Place the speakers further away from the TV set.

### If howling occurs

Reposition the speakers or turn down the volume on the amplifier.

### On placement

- Do not set the speakers in an inclined position.
- Do not place the speakers in locations that are:
  - Extremely hot or cold
  - Dusty or dirty
  - Very humid
  - Subject to vibrations
  - Subject to direct sunlight

### On cleaning

Clean the speaker cabinets with a soft cloth lightly moistened with a mild detergent solution or water. Do not use any type of abrasive pad, scouring powder or solvent such as alcohol or benzine.

If you have any questions or problems concerning your speaker system, please consult your nearest Sony dealer.

## Hooking up the system

Connect the speaker system to the speaker output terminals of an amplifier.

Make sure power to all components (included the subwoofer) is turned off before starting the hook-up.

### Hookup (for SA-VE525)

This configuration is used when the amplifier is connected to a DVD player, LD player, VCR or other video devices.

### Hookup (for SA-VE525)

Try this configuration instead of "Hookup " in the following situations:
 

- When there are no jacks on the amplifier for a subwoofer.
- When you want a stronger bass sound from the subwoofer.

### Hookup (for SA-VE522)

This configuration is used when the amplifier is connected to a CD player, MD deck, cassette deck, or other audio devices.

### Notes

- Make sure the plus (+) and the minus (-) terminals on the speakers are matched to the corresponding plus (+) and minus (-) terminals on the amplifier.
- Be sure to tighten the screws of the speaker terminals securely as loose screws may become a source of noise.
- Make sure all connections are firm. Contact between bare speaker wires at the speaker terminals may cause a short-circuit.
- Do not connect the subwoofer to the amplifier's CENTER output terminal (which is for Dolby Pro Logic or Dolby Digital (AC-3)). No bass sound will output from the subwoofer if you do.
- For details regarding the connections on the amplifier side, refer to the manual that was provided with your amplifier.

### Tip

All striped wires are minus (-) in polarity, and should be connected to the minus (-) speaker terminals.

## Positioning the speakers

### Location of each speaker

Each speaker should face the listening position. Better surround effect will result if all speakers are set at the same distance from the listening position.

Place the front speakers at a suitable distance to the left and right of the television.  
Place the subwoofer on either side of the television.  
Place the center speaker on the top-center of the TV set.  
The placement of rear speakers greatly depends on the configuration of the room. The rear speakers may be placed on both sides of the listening position or behind the listening position .

### Tips

- Movies are best enjoyed in a room that produces no echoes (as in one with surrounding curtains).
- Music (especially classical music) is best enjoyed in a room that produces some echo.

## Positioning the center speaker (SA-VE525 only)

Attach the center speaker to the supplied speaker stand and place it on a top of the TV set.

For optimum listening enjoyment, the speaker should face directly towards the listener. Adjust the angle of the speaker stand for that purpose.

- Pass the speaker cord into the hole on the back of the stand and out from the hole at the center of the stand.
- Connect the speaker cord to the speaker terminal.
- Using the supplied screw and washer, secure the speaker to the stand.

- Adjust the angle of the speaker stand. Loosen the two screws under the base to adjust the angle. Then tighten them again afterwards.

### Note

Do not remove the supplied speaker grille from the speaker while attaching the speaker to the speaker stand.

- Adjust the angle of the speaker stand. Loosen the two screws under the base to adjust the angle. Then tighten them again afterwards.

### Setting the speakers

To prevent speaker vibration or movement while listening, attach the supplied foot pads to the front speakers and rear speakers\*. \*SA-VE525 only

### The optional speaker stands

For greater flexibility in the positioning of the speakers, use the optional WS-FV10A (floor stand), WS-TV10A (TV stand), or WS-WV10A (wall mount bracket) speaker stand (available only in certain countries).

### Tip

The height of the front speakers should be adjusted to about the center of the TV screen .

## Listening to the sound (SA-VE525 only)

First, turn down the volume on the amplifier. The volume should be set to minimum before you begin playing the program source.

- Turn on the amplifier and select the program source.
- Press POWER on the subwoofer. The ON/STANDBY indicator on the subwoofer lights up green.
- Play the program source.

### Power turns on and off automatically — Auto power on/off function

When the subwoofer is on (i.e., the ON/STANDBY indicator lights up green) and there is no signal input for a few minutes, the ON/STANDBY indicator changes to red and the subwoofer enters power saving mode. While in this mode a signal is input to the subwoofer, the subwoofer automatically turns on (auto power on/off function). To turn this feature off, slide the POWER SAVE switch on the rear panel to OFF.

### Note

If you turn down the volume level of the amplifier too low, the auto power on/off function may activate, causing the subwoofer to enter power saving mode.

## Adjusting the sound

Slight adjustments to the system can enhance your sound enjoyment.

## Adjusting the subwoofer (SA-VE525 only)

- Set MODE according to the program source as follows:
 

Source	MODE
DVD, LD, video cassette or other video source	MOVIE
MD, CD, cassette tape or other audio source	MUSIC
- Rotate LEVEL to adjust the volume. Set the volume level to best suit your preference according to the program source.

### Notes

- Some amplifier functions for enhancing the sound may cause distortion in the subwoofer. If such distortion occurs, turn off those functions.
- To enjoy high-quality sound, do not turn the subwoofer volume too high.
- To increase the bass sound from the subwoofer, connect the system using "Hookup ".
- The bass sound is enhanced in MOVIE mode rather than in MUSIC mode. Therefore, if you change the mode to MOVIE while listening to some sources that do not include the bass sound, you may not be able to get the effect.

## Setting amplifier to enjoy movies (SA-VE525 only)

For the Dolby Digital (AC-3) If your amplifier is connected internally or externally with a Dolby Digital (AC-3) processor, you should use the setup menus for the amplifier to specify the parameters of your speaker system.

See the table below for the proper settings. For details on the setting procedure, refer to the manual that was provided with your amplifier.

Select Micro Satellite Position if a Sony amplifier provides it.

### When "Hookup " is used (Speaker setup)

For	Set to
Front speakers	SMALL
Center speaker	SMALL
Rear speakers	SMALL
Subwoofer	ON (or YES)

### When "Hookup " is used (Speaker setup)

For	Set to
Front speakers	LARGE
Center speaker	SMALL
Rear speakers	SMALL
Subwoofer	OFF (or NO)

### For the Dolby Pro Logic

If your amplifier is connected internally or externally with a Dolby Pro Logic processor, you should set the surround effect mode to "NORMAL" on the amplifier for your particular speaker system.

For details on the setting procedure, refer to the manual that was provided with your amplifier.

## Troubleshooting

Should you encounter a problem with your speaker system, check the following list and take the indicated measures. If the problem persists, consult your nearest Sony dealer.

### There is no sound from the speaker system.

- Make sure all the connections have been correctly made.
- Make sure the volume on the amplifier has been turned up properly.
- Make sure the program source selector on the amplifier is set to the proper source.
- Check if headphones are connected. If they are, disconnect them.

### There is distortion in the subwoofer sound output.

- Check if any sound-enhancing functions have been activated on the amplifier. If they have, turn them off.

### There is hum or noise in the speaker output.

- Make sure all the connections have been correctly made.
- Make sure none of the audio components are positioned too close to the TV set.

### The sound has suddenly stopped.

- Make sure all the connections have been correctly made. Contact between bare speaker wires at the speaker terminals may cause a short-circuit.

## Specifications

SA-VE525/VE522	
<b>SS-MS525 (front, center, and rear speakers)</b>	
Speaker system	Full range × 2, magnetically shielded
Speaker units	5 cm, ballance drive type
Enclosure type	Bass reflex
Rated impedance	8 ohms
Power handling capacity	
Maximum input power:	120 watts
Sensitivity level	87 dB (1 W, 1 m)
Frequency range	120 Hz - 20,000 Hz
Dimensions (w/h/d)	When attached speaker grille: Approx. 89 × 144 × 130 mm When attached supplied speaker stand: Approx. 89 × 128 × 143 mm (pointed upwards) Approx. 89 × 122 × 143 mm (pointed downwards)
Mass	When attached speaker grille: Approx. 750 g When attached supplied speaker stand: Approx. 850 g

<b>SA-WMS525 (subwoofer)</b>	
Speaker system	Active subwoofer, magnetically shielded
Speaker unit	Woofer: 20 cm, cone type
Enclosure type	Advanced SAW type
Reproduction frequency range	26 Hz - 250 Hz
<b>Amplifier section</b>	
Rated Power Output	120 W (8 ohms 20 Hz - 20 kHz, THD 0.8%)
<b>Inputs</b>	
LINE IN (input pin jack)	
SPEAKER IN (input terminals)	
<b>Outputs</b>	
LINE OUT (output pin jack)	
SPEAKER OUT (output terminals)	
<b>General</b>	
Power requirements	220 - 230 V AC, 50/60 Hz
European model:	220 - 240 V AC, 50/60 Hz
Australian model:	90 W
Power consumptions	1 W (standby mode)
Dimensions (w/h/d)	Approx. 230 × 392 × 464 mm, including front grille
Mass	Approx. 13.2 kg

### Supplied accessories

SA-VE525	
Foot pads (16)	
Center speaker stand (1)	
Screw (for the center speaker stand) (1)	
Washer (for the center speaker stand) (1)	
Audio connecting cord (1)	
Speaker connecting cords, 10 m (2)	
Speaker connecting cords, 3.5 m (3)	
Speaker connecting cords, 2.5 m (2)	
SA-VE522	
Foot pads (8)	
Audio connecting cord (1)	
Speaker connecting cords, 3.5 m (2)	
Speaker connecting cords, 2.5 m (2)	

Design and specifications are subject to change without notice.

## Français

### AVERTISSEMENT

Pour éviter tout risque de feu ou de choc électrique, ne pas exposer cet appareil à la pluie ou à l'humidité. Pour ne pas risquer un incendie, ne couvrez pas les orifices d'aération de l'appareil avec des journaux, nappes, rideaux, etc. Et ne placez pas de bougies allumées sur l'appareil.  
Ne placez pas de vase sur l'appareil. Ceci ferait courir un risque d'incendie ou d'électrocution.  
Pour éviter tout choc électrique, ne pas ouvrir le coffret. Confier l'entretien à un personnel qualifié.

N'installez pas l'appareil dans un espace confiné comme dans une bibliothèque ou un meuble encastré.

## A propos de ce manuel

Les instructions de ce manuel concernent les systèmes Micro Satellite Sony, SA-VE525 et SA-VE522.

### Différences entre les systèmes

- SA-VE525
  - Les SA-VE525 sont des systèmes acoustiques à 5.1 canaux, comprenant deux enceintes avant, deux enceintes arrière, une enceinte centrale et un caisson de grave. Ces deux systèmes supportent les fonctions Digital Cinema Sound de Sony, Dolby® Pro Logic et Dolby Digital (AC-3) et sont donc destinés à la reproduction du son cinématographique.
- SA-VE522
  - Les SA-VE522 comprennent deux enceintes avant et un caisson de grave. Ils sont donc destinés à l'écoute de la musique.

\* Fabriqué sous licence de Dolby Laboratories. DOLBY, le symbole double-D , PRO LOGIC et™ Dolby Digital (AC-3) sont des marques de Dolby Laboratories.

Toute différence de fonctionnement est clairement indiquée dans le texte, par exemple, "SA-VE525 seulement".

## Précautions

### Sécurité

- Avant de mettre le système en service, assurez-vous que sa tension de fonctionnement est identique à celle de l'alimentation secteur locale.
- Le système n'est pas isolé de la source d'alimentation secteur tant qu'il reste branché sur la prise murale, même s'il a été éteint.
- Débranchez le système s'il ne doit pas être utilisé pendant longtemps. Pour débrancher le cordon, tirez sur la fiche. Ne jamais tirer sur le cordon proprement dit.
- Si un liquide ou un solide pénètre dans le système, débranchez le cordon d'alimentation du système et faites vérifier le système par un professionnel avant de l'utiliser à nouveau.
- Le cordon d'alimentation secteur doit être remplacé seulement dans un centre de service compétent.

### Fonctionnement

- Ne pas faire fonctionner le système acoustique continuellement à une puissance dépassant sa puissance d'entrée maximale.
- Si la polarité des liaisons d'enceintes n'est pas correcte, les graves seront faibles et la position des différents instruments de musique indistincte.
- Le contact des fils de haut-parleur dénudés au niveau des bornes du haut-parleur peut provoquer un court-circuit.
- Avant de raccorder les enceintes, éteignez l'amplificateur pour éviter d'endommager le système acoustique.

### Si les couleurs sur un écran de télévision sont anormales

Le système acoustique est isolé contre le magnétisme et peut être installé près d'un téléviseur. Cependant, avec certains téléviseurs, vous pourriez observer des anomalies de couleur.

Si les couleurs sont anormales...  
→Éteignez le téléviseur et rallumez-le 15 à 30 minutes plus tard.

Si les couleurs restent anormales...  
→Éloignez les enceintes du téléviseur.

### Si un sifflement se produit

Repositionnez les enceintes ou réduisez le volume sur l'amplificateur.

### Emplacement

- N'installez pas les haut-parleurs en position inclinée.
- N'installez pas les enceintes aux endroits suivants:
  - Extrêmement chauds ou froids
  - Poussiéreux ou sales
  - Très humides
  - Sujets à des vibrations
  - Exposés à la lumière directe du soleil

### Nettoyage

Nettoyez les coffrets d'enceintes avec dans un chiffon doux légèrement mouillé d'une solution détergente neutre ou d'eau. Ne pas utiliser de tampons abrasifs, de poudre à récurer ni de solvants, comme l'alcool ou la benzine.

Pour toute question ou difficulté concernant votre système acoustique, veuillez consulter votre revendeur Sony.

## Raccordement du système acoustique

Raccordez le système acoustique aux bornes d'enceintes de l'amplificateur.

Avant de raccorder les cordons, assurez-vous que tous les appareils (caisson de grave compris) sont hors tension.

**Raccordement (SA-VE525)**  
Cette configuration doit être utilisée lorsque l'amplificateur est raccorder à un lecteur DVD, un lecteur LD, un magnéto-copie ou à un autre appareil vidéo.

**Raccordement (SA-VE525)**  
Essayez cette configuration au lieu du "Raccordement " dans les situations suivantes:

- l'amplificateur n'a pas de prises pour le raccordement d'un caisson de grave.
- vous voulez que le caisson de grave produise un son grave plus puissant.

**Raccordement (SA-VE522)**  
Cette configuration doit être utilisée lorsque l'amplificateur est raccorder à un lecteur CD, une platine MD, une platine à cassette ou un autre appareil audio.

### Remarques

- Assurez-vous que les bornes plus (+) et moins (-) des enceintes correspondent aux bornes plus (+) et moins (-) de l'amplificateur.
- Veillez à bien serrer les vis des bornes d'enceintes, car des vis desserrées peuvent être une source de bruit.
- Veillez à insérer à fond les fils dans les bornes. Le contact des fils de haut-parleur dénudés au niveau des bornes du haut-parleur peut provoquer un court-circuit.
- Ne raccordez pas le caisson de grave à la borne de sortie CENTER de l'amplificateur (qui est réservé au Dolby Pro Logic ou au Dolby Digital (AC-3)). Sinon, le caisson de grave ne diffusera pas de graves.
- Pour les connexions côté amplificateur, reportez-vous au manuel fourni avec l'amplificateur.

### Conseil

Tous les fils rayés présentent une polarité négative (-) et doivent être raccordés aux bornes négatives (-) du haut-parleur.

## Emplacement des enceintes

### Position de chaque enceinte

Chaque enceinte doit être dirigée vers la position d'

